

BALL VALVES AND BIB COCKS FOR GAS

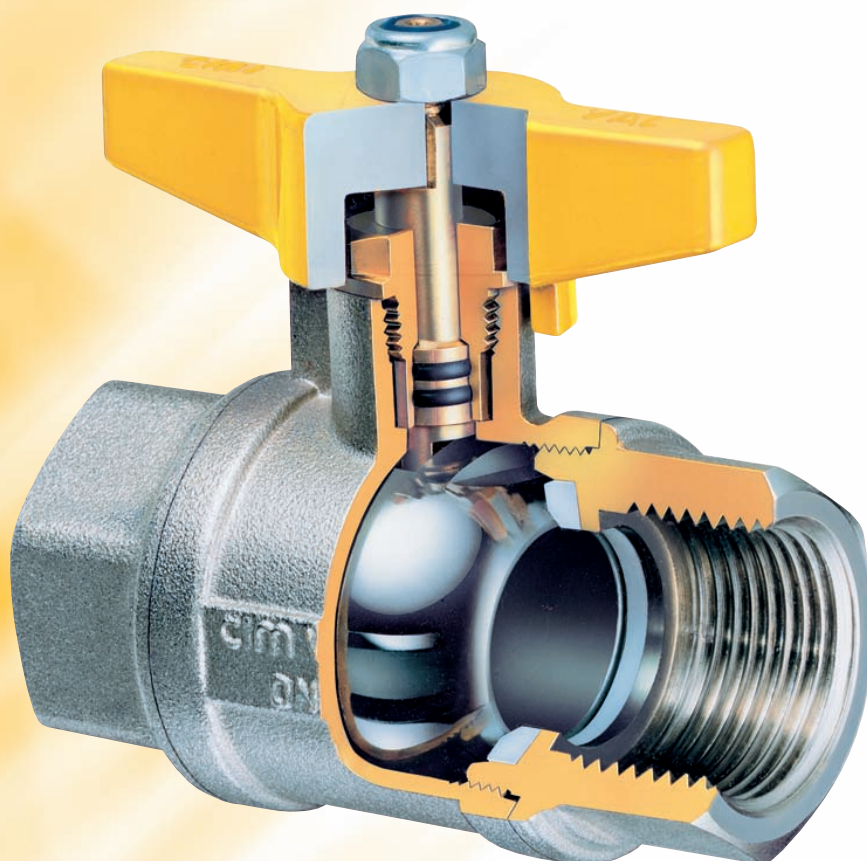

valve
cimberio[®]
technological solutions

Cimberio gas ball valves

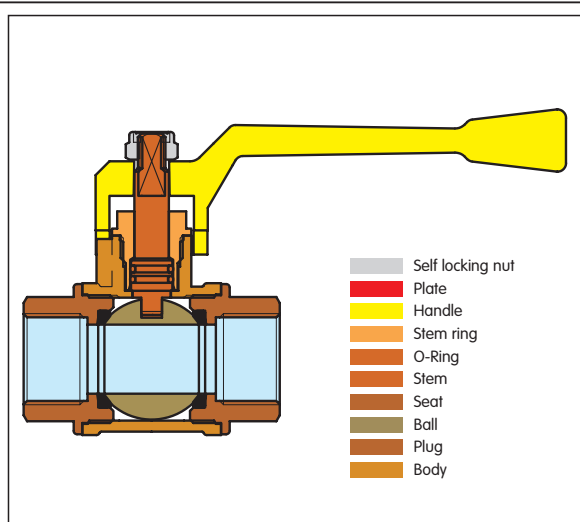

The gas ball valves are certified by BG Technology and DIN DVGW in accordance with the European Standard EN 331:1998. They are approved in accordance with the European standard for gas appliances (90/396/EEC). Manufactured in accordance with EN ISO 9001:2000 they are suitable for gas at low pressure for the distribution of:

Natural gas: gas obtained from petroleum (Methane) and propane/air mixtures.

Town gas: gas produced according to different process (Cracking – Coacking, etc.)

Liquid gas: propane and mixtures of propane/butane.

The gas ball valves are best for services that require frequent valve operation, and where the ball is kept either fully opened or closed. The straight through design offers little resistance to flow and reduces pressure drop to a minimum.

DN	Ø mm.	CM Operating torque in Nm.			CS Starting torque in Nm.			MT Stem breaking torque in Nm.			KV Pressure drop		
		CIM 10G	CIM 12G	CIM 16G	CIM 10G	CIM 12G	CIM 16G	CIM 10G	CIM 12G	CIM 16G	CIM 10G	CIM 12G	CIM 16G
1/4	10	1	1		2	2		10	10		3,5	3,5	
3/8	10	1	1		2	2		10	10		4,8	4,8	
1/2	15	3	3	1,5	6	6	3	20	18	24	12	12	12
3/4	20	4	4	2	10	10	4	45	28	24	23	23	23
1"	25	5	5	4	12	12	7	45	28	26	30	30	30
1 1/4"	32	8	8	5	17	17	10	92	42	26	65	65	65
1 1/2"	40	10	10	8	22	22	16	93	80	88	131	131	131
2"	50	13	13	11	26	26	20	93	80	88	214	214	214
2 1/2"	63	15	15		32	32		280	280		345	345	
3"	76	17	17		36	36		280	280		550	550	
4"	100	19	19		40	40		550	550		950	950	

KV: FLOW RATE IN m³/h WITH A PRESSURE DROP OF 1 mbar-GAS (SG=0,6)

THREADING:

Series T10G - T12G - T11G - T16G - T17G

Female parallel threads to ISO 7/1 - EN10226-Rp (Standard)

Series T16.1NPT - T17.1NPT - 12GNPT - 11GNPT

American NPT threads ANSI B1.20.1

BALLS:

All Cimberio balls are full bore, solid and linear type to avoid flow drop and turbulences. Mirror-like surface, micro-smooth finish, chrome plated.

SAFETY HANDLE:

After extraction and 180° turn of handle, lever or butterfly type, it is possible to block the valve in the "open-closed" position.

TIGHTNESS ANGLE:

The tightening seats dimensions and the ball diameter guarantee a tightness angle ≥ 15 for series T10 and ≥ 10 for all other series.

SEALING MATERIAL FOR THREADS:

Anaerobic adhesive according to EN 751-1.

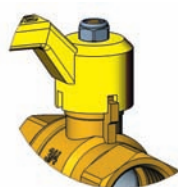

safety handle

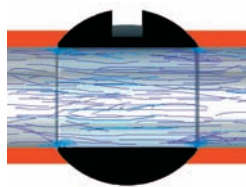

ball

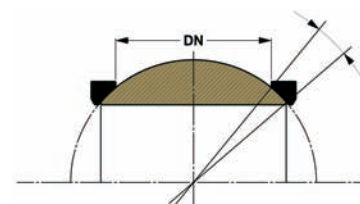

tightness angle

Cimberio gas ball valves

WORKING PRESSURES (MOP) EN 331:

- T10G series** sizes from 1/4 up to 4" MOP 5 class;
- T12G series** sizes from 1/4 up to 4" MOP 5 class;
- T16G series** sizes from 1/4 up to 2" MOP 5 class.

TEST PRESSURES:

According to EN 331:1998.

WORKING TEMPERATURES (MOT):

According to European Standard EN 331 and 97/23/CE. All series have a working limit, for gas family 1-2-3 from -20°C up to 60°C. Class -20°C.

RESISTANCE

All series can withstand a pressure 5 times rated PN, as prescribed by UL 125 American standard.

PRESSURE/TEMPERATURE RATINGS

T10G SERIES

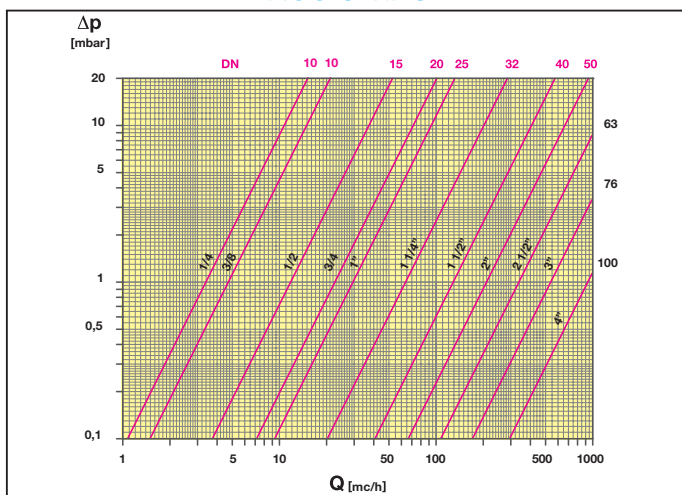

T11G SERIES

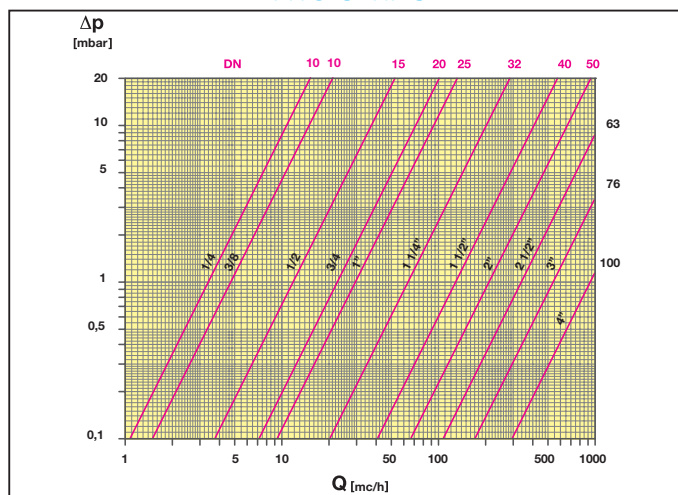

T16G SERIES

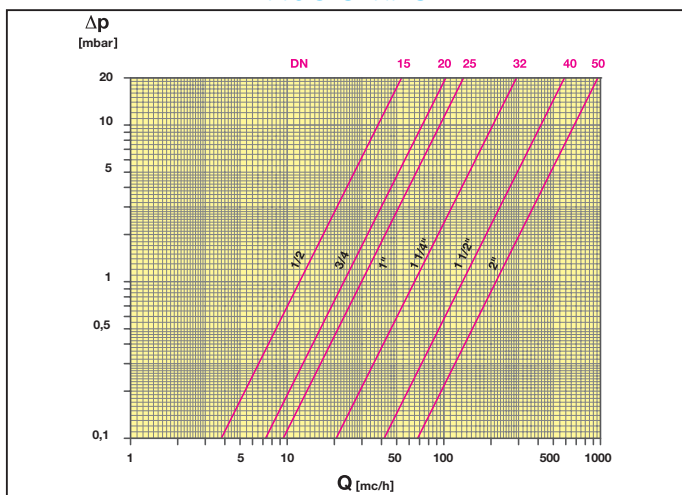

T16.1NPT SERIES

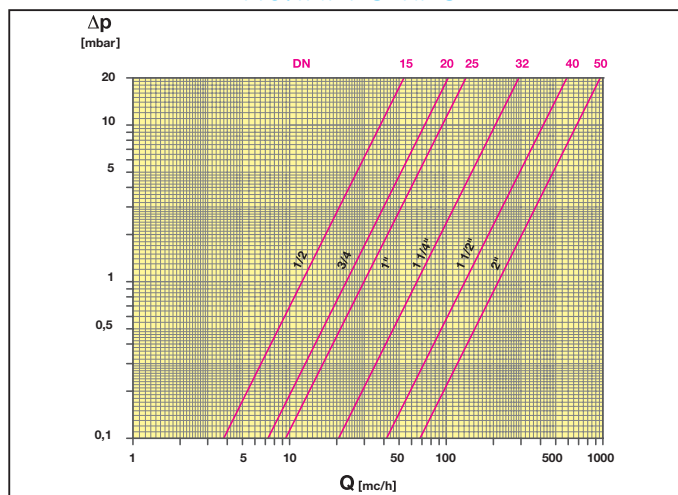

MARKINGS

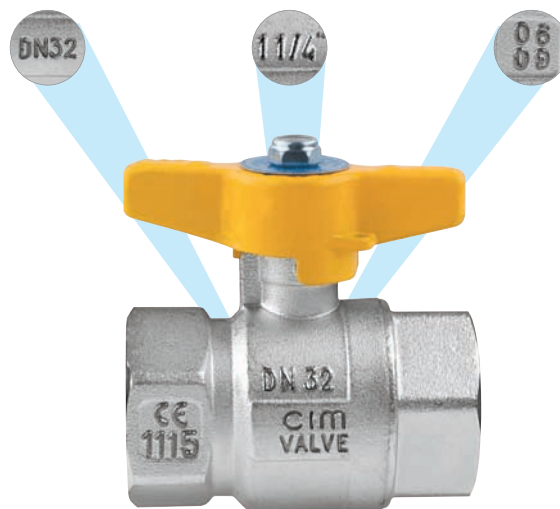
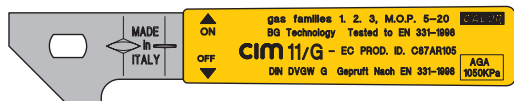
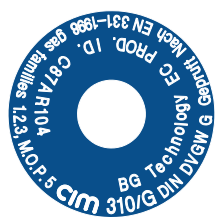

DIN-DVGW-Baumusterprüfzertifikat
DIN-DVGW type examination certificate

NG-4312AU2427

Anwendungsbereich / field of application: Produkte der Gasversorgung / products of gas supply

Zertifizierer / issuer of certificate: Cav. Uff. GIACOMO CIMBERIO S.p.A. - Via Torchio, 57 - I-20017 San Maurizio d'Oraglio

Hersteller / manufacturer: Modulo Industriale S.p.A. - Via Torchio, 57 - I-20017 San Maurizio d'Oraglio

Produktart / product category: gas fittings: shut-off valve for gas installation - MOP 5 (4312)

Produktbezeichnung / product description: softvalve in passive style for the gas installation optionally with reduction

Modell / model: CM... (F2)

Publizierte / list reports: type testing: 02/12/02/142 from 02.07.2004 (88)

Prüfgrundlagen / basis of type examination: DIN EN 331 01.04.1998

Abschlußdatum / AZ / date of issue / see no.: 29.10.2009 / 00-0565-DNV

Signature: [Handwritten Signature]

Stamp: DVGW

4-20 NG-4312AU2427

Typ / type	Technische Daten / technical data	Bemerkungen / remarks
CM... (F2)	nominal diameter DN 10	
CM... (F2)	nominal diameter DN 15	
CM... (F2)	nominal diameter DN 20	
CM... (F2)	nominal diameter DN 25	
CM... (F2)	nominal diameter DN 32	
CM... (F2)	nominal diameter DN 40	
CM... (F2)	nominal diameter DN 50	

Ausführungsvarianten / type variants:

Erklärungen / explanations:

Zertifizierungspflichtige Bauteile / certified components:

Regist.-Nr. / registration no.	Bezeichnet (Produktart) / designates (product type)	Modelltyp / model type	Hersteller / manufacturer
NG-414490273	Gelling and joining materials for internal and external gas applications and gas fittings	LOXAL 95-BELOREAL LORAL s.r.l.	
NG-414490288	Materials for manometers for gas applications and equipment for	ME 2010/10/05 20170	Furgon S.p.A.
NG-414490290	Stating material made of elastomers for ME 2010/10/05 20170		Furgon S.p.A.
NG-414490296	Stating material made of elastomers for 1000 01/05/2001 01/10		AS TEX S.p.A.

Verwendungsabweichung / Bemerkungen / notes of application / remarks:

Pressure class: MOP 5 (pressure: 5 bar) ambient temperature range: 0...40°C

EC Type Examination Certificate

Issued by BG Technology, Certification Services
Gas Research & Technology Centre, Ashby Road, Loughborough, Leicestershire LE11 3QR

NOTIFIED BODY NUMBER 0001 JOB NO. 021103

CERTIFICATE NO.: BGEC-0796/06 Rev 1

DATE: 3 March 1998

ORIGINAL/SUPPLEMENTARY: Original

MANUFACTURER: CAV.UFF. GIACOMO CIMBERIO S.P.A. 20017 S. MAURIZIO D'OPAGLIA (NO) VIA TORCHIO, 57 ITALY

PRODUCT TYPE: Manually Operated 1/2 Turn Ball Valve

MODEL DESIGNATION: CM 110G SERIES

SIZE / DIMENSIONS: 1in, 1.5in and 2in

DESIGNATION COUNTRY: All EU Countries

EC PRODUCT IDENT. NO.: C28A104

Signature: [Handwritten Signature]

Stamp: BG Technology, P.G. Johnson Manager, BG Technology Certification Services

EC Type Examination Certificate

Issued by BG Technology, Certification Services
Gas Research & Technology Centre, Ashby Road, Loughborough, Leicestershire LE11 3QR

NOTIFIED BODY NUMBER 0001 JOB NO. 029213

CERTIFICATE NO.: BGEC-0796/06 Rev 1

DATE: 3 March 1998

ORIGINAL/SUPPLEMENTARY: Supplementary

MANUFACTURER: CAV.UFF. GIACOMO CIMBERIO S.P.A. 20017 S. MAURIZIO D'OPAGLIA (NO) VIA TORCHIO, 57 ITALY

PRODUCT TYPE: Manually Operated 1/2 Turn Ball Valve

MODEL DESIGNATION: CM 11 SERIES, CM 11G SERIES, CM 11G SERIES

SIZE / DIMENSIONS: 1in, 1.5in and 2in

DESIGNATION COUNTRY: All EU Countries

EC PRODUCT IDENT. NO.: C28A104

Signature: [Handwritten Signature]

Stamp: BG Technology, P.G. Johnson Manager, BG Technology Certification Services

Certificate of Compliance

Certificate: 1197625 (122300) Master Contract: 10000

Project: 1270119 Date Issued: 2004/08/11

Issued to: CAV. UFF. GIACOMO CIMBERIO S.p.A. - Via Torchio, 57 - San Maurizio d'Oraglio - Parma, Parma 20017 - Italy - Attention: Tulliano Gualdrini

The products listed below are eligible to bear the CSA Mark shown with adjacent indicators 'C' and 'US'

PRODUCTS:

- CLASS 3373 92 - VALVES (GAS) Manually Operated For Use in House - Piping System Certified to U.S. Standards
- CLASS 3373 81 - VALVES (GAS) - Appliance Connector Certified to U.S. Standards
- CLASS 3373 88 - VALVES (GAS) - General Use Certified to U.S. Standards
- CLASS 3373 12 - VALVES (GAS) - Manually Operated For Use in Piping System Certified to U.S. Standards
- CLASS 3373 89 - VALVES (GAS) - Manually Operated For Use in House - Piping System Certified to U.S. Standards
- CLASS 3373 12 - VALVES (GAS) - Appliance Connector Certified to U.S. Standards
- CLASS 3373 81 - VALVES (GAS) - Appliance Connector Certified to U.S. Standards
- CLASS 3373 88 - VALVES (GAS) - General Use Certified to U.S. Standards

Signature: [Handwritten Signature]

Stamp: Tulliano Gualdrini, Manager of Certification Services

Certificate of Compliance

Certificate: 1440010 (112200) Master Contract: 10000

Project: 1111000 Date Issued: 2004/11/08

Issued to: CAV. UFF. GIACOMO CIMBERIO S.p.A. - Via Torchio, 57 - San Maurizio d'Oraglio - Parma, Parma 20017 - Italy - Attention: Tulliano Gualdrini

The products listed below are eligible to bear the CSA Mark shown with adjacent indicators 'C' and 'US'

PRODUCTS:

- CLASS 3373 94 - VALVES (GAS) Manually Operated Manifold for Use in Piping System Certified to U.S. Standards
- CLASS 3373 10 - VALVES (GAS) - Lever Operated Non-Lubricated Shut-off System Certified to U.S. Standards
- CLASS 3373 92 - VALVES (GAS) Manually Operated For Use in House - Piping System Certified to U.S. Standards
- CLASS 3373 12 - VALVES (GAS) - Manually Operated For Use in Piping System Certified to U.S. Standards
- CLASS 3373 81 - VALVES (GAS) - Appliance Connector Certified to U.S. Standards
- CLASS 3373 88 - VALVES (GAS) - General Use Certified to U.S. Standards

Signature: [Handwritten Signature]

Stamp: Tulliano Gualdrini, Manager of Certification Services

Underwriters Laboratories Inc.

CAV. UFF. GIACOMO CIMBERIO S.P.A. - VIA TORCHIO, 57 - SAN MAURIZIO D'OPAGLIA (NO) - ITALY

RE: Project Number(s) - 01NK0006

YQXZ Compressed Gas Shutoff Valves May 26, 2003

CAV. UFF. GIACOMO CIMBERIO S.P.A. - VIA TORCHIO, 57 - SAN MAURIZIO D'OPAGLIA (NO) - ITALY M018523

LOOK FOR LISTING MARK ON PRODUCT

Underwriters Laboratories Inc.

CAV. UFF. GIACOMO CIMBERIO S.P.A. - VIA TORCHIO, 57 - SAN MAURIZIO D'OPAGLIA (NO) - ITALY

RE: Project Number(s) - 01NK0006

YKPV Gas Shutoff Valves May 26, 2003

CAV. UFF. GIACOMO CIMBERIO S.P.A. - VIA TORCHIO, 57 - SAN MAURIZIO D'OPAGLIA (NO) - ITALY M018523

LOOK FOR LISTING MARK ON PRODUCT

EC Type Examination Certificate

Issued by BG Technology, Certification Services
Gas Research & Technology Centre, Ashby Road, Loughborough, Leicestershire LE11 3QR

NOTIFIED BODY NUMBER 0001 JOB NO. 021103

CERTIFICATE NO.: BGEC-0796/06 Rev 1

DATE: 3 March 1998

ORIGINAL/SUPPLEMENTARY: Original

MANUFACTURER: CAV.UFF. GIACOMO CIMBERIO S.P.A. 20017 S. MAURIZIO D'OPAGLIA (NO) VIA TORCHIO, 57 ITALY

PRODUCT TYPE: Manually Operated 1/2 Turn Ball Valve with Strainer Filter

MODEL DESIGNATION: CM 120G SERIES

SIZE / DIMENSIONS: 1in, 1.5in and 2in

DESIGNATION COUNTRY: All EU Countries

EC PRODUCT IDENT. NO.: C28A104

Signature: [Handwritten Signature]

Stamp: BG Technology, P.G. Johnson Manager, BG Technology Certification Services

Ball valves cim series T10/G – T12/G

Stem - Cap:

Turned from brass bar:
EN 12165 CW 617 N (DIN 50330-6)

Handle: Aluminium alloy EN AB 46100,

epoxy painted

Nut: Self locking type

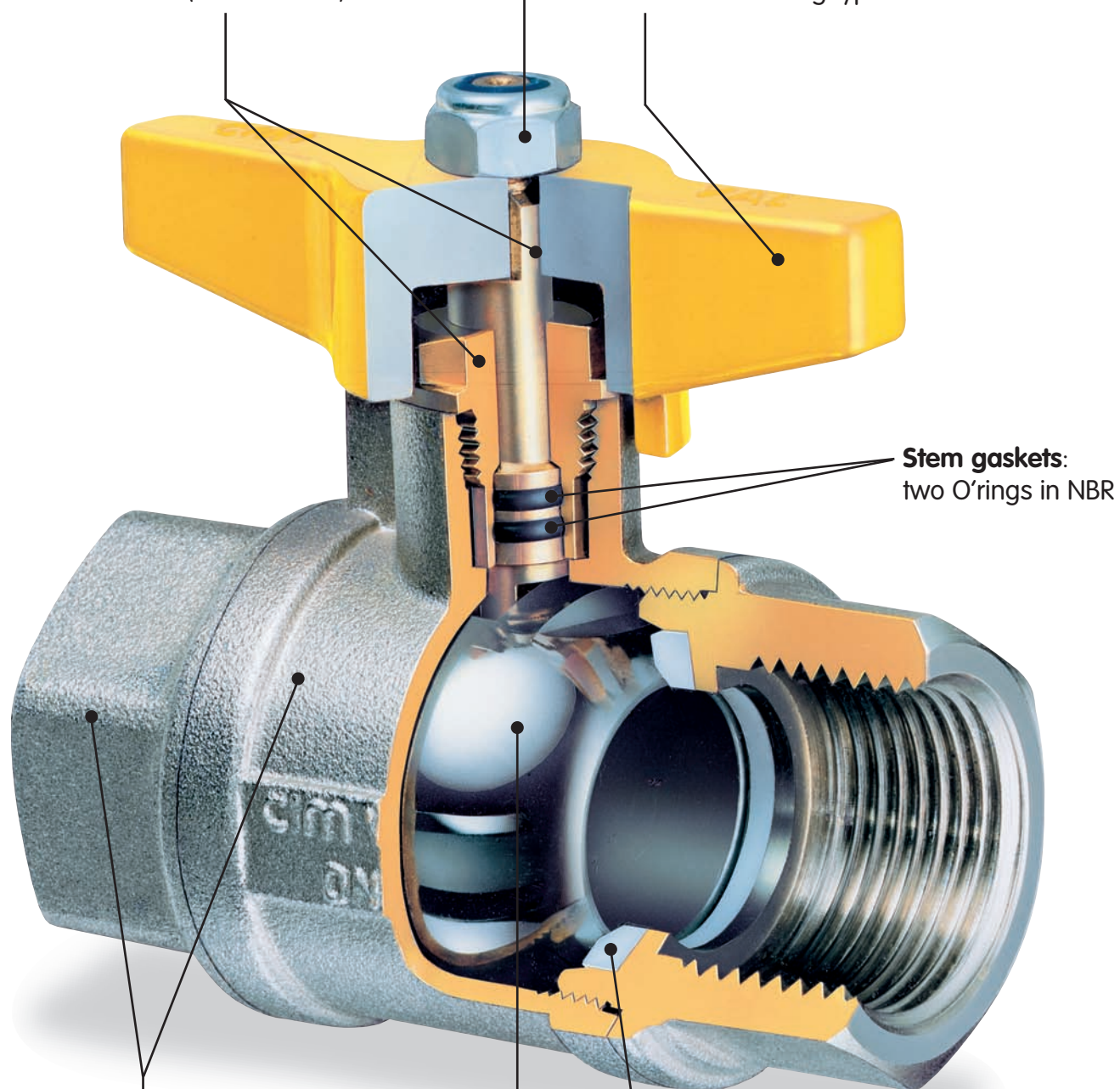

Stem gaskets:
two O'rings in NBR

Body - screwed ends;

Hot pressed brass bar:
EN 12165 CW 617 N (DIN 50930-6)

Ball - gaskets

Conical rings in pure P.T.F.E.,
hardness 50÷60 Shore D

Ball: hot pressed from brass bar
EN 12165 CW 617 N (DIN 50930-6)
Mirror-like surface, micro-smooth finish,
chrome plated.

Chemical composition - Brass alloy to EN 12164-12165 CW617N-DIN 50930-6

Cu %	Pb %	Sn %	Ni %	Fe %	Al %	As %	Mn %	Others %	Zn %
57-59	1,6-2,2	Max. 0,3	Max. 0,2	Max. 0,3	Max. 0,8	Max. 0,1	Max. 0,1	Max. 0,25	Rem.



cim 10 G

FULLWAY BALL VALVE FOR GAS - EN 331 - T10 SERIES

cim 310 G

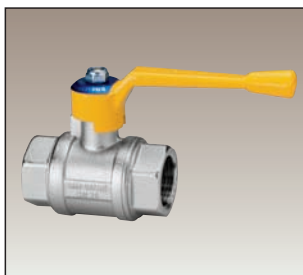

DN	1/4	3/8	1/2	3/4	1"	1 1/4"	1 1/2"	2"	2 1/2"	3"	4"
Box Cim 10 G	50	50	25	16	12	6	5	3	2	1	1
Cart. Cim 10 G	100	100	100	64	48	24	20	12	4	2	2
Box Cim 310 G	50	50	35	20	15	10	6	3			
Cart. Cim 310 G	100	100	140	80	60	40	24	12			

cim 12 G

FULLWAY BALL VALVE FOR GAS - EN 331 - T12 SERIES

cim 312 G



DN	1/4	3/8	1/2	3/4	1"	1 1/4"	1 1/2"	2"	2 1/2"	3"	4"
Box Cim 11 G	50	50	40	25	16	10	6	4	2	2	2
Cart. Cim 11 G	200	200	160	100	64	40	24	16			
Box Cim 12 G	50	50	40	25	16	10	6	4			
Cart. Cim 12 G	200	200	160	100	64	40	24	16			



cim 16 G

FULLWAY BALL VALVE FOR GAS - EN 331 - T16 SERIES

cim 316 G

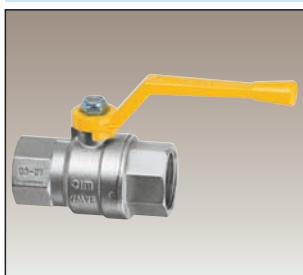

DN	1/4	3/8	1/2	3/4	1"	1 1/4"	1 1/2"	2"	2 1/2"	3"	4"
Box Cim 16 G			40	25	16	10	6	4			
Cart. Cim 16 G			160	100	64	40	24	16			
Box Cim 316 G			50	30	20	10	7	4			
Cart. Cim 316 G			200	120	80	40	28	16			



cim 12 GNPT

FULLWAY BALL VALVE FOR GAS - UL-CSA NPT THREAD T12

cim 312 GNPT



DN	1/4	3/8	1/2	3/4	1"	1 1/4"	1 1/2"	2"	2 1/2"	3"	4"
Box Cim 12 GNPT	50	50	40	25	16	10	6	4	2	2	2
Cart. Cim 12 GNPT	100	100	160	100	64	40	24	16			
Box Cim 312 GNPT	50	50	50	30	20	12	7	4			
Cart. Cim 312 GNPT	100	100	200	120	80	48	28	16			

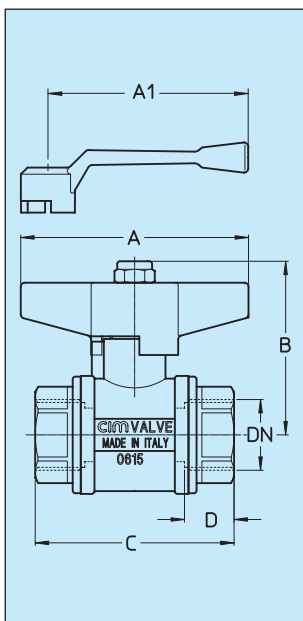

DN	1/4	3/8	1/2	3/4	1"	1 1/4"	1 1/2"	2"	2 1/2"	3"	4"	
Cim 10 G	Grms.	180	185	340	610	830	1325	1730	3000	6630	10360	13500
Cim 310 G	A	50	50	70	85	85	100	100	100	-	-	-
	A1	80	80	100	120	120	150	150	150	240	240	310
	B	50	50	53	65	69	83	89	96	121	132	155
	C	47	50	64	74	88	101	105	130	158	183	222
	D	12,5	13,5	17	18,5	22	24	23	28,5	31	35	43
Cim 12 G	Grms.	115	120	220	360	590	915	1355	2060	4255	6210	10000
Cim 312 G	A	43	43	50	70	70	85	100	100	-	-	-
Cim 11 G	A1	65	65	80	100	100	120	150	150	240	240	310
Cim 12 GNPT	B	36	36	52	56	60	73	89	96	121	132	155
Cim 11 GNPT	C	45	47	61	68	82	92	106,5	124,5	151	171	206
	D	11,5	12,5	17	18,5	21	22,5	23	26,5	27	28	35
Cim 16 G	Grms.	-	-	190	300	495	760	1170	1740	-	-	-
Cim 17 G	A	-	-	55	55	75	75	105	105	-	-	-
	A1	-	-	90	90	110	110	150	150	-	-	-
	B	-	-	49,5	54	63	72	83	90	-	-	-
	C	-	-	62	69	83,5	96,5	109,5	130,5	-	-	-
	D	-	-	17,5	19	22	25	25	29	-	-	-
Cim 12 GNPT	Grms.	115	120	220	360	590	915	1355	2060	-	-	-
Cim 312 GNPT	A	43	43	50	70	70	85	100	100	-	-	-
	A1	65	65	80	100	100	120	150	150	-	-	-
	B	36	36	52	56	60	73	89	96	-	-	-
	C	45	47	61	68	82	92	106,5	124,5	-	-	-
	D	11,5	12,5	17	18,5	21	22,5	23	26,5	-	-	-



cim 16.1 GNPT FULLWAY BALL VALVE FOR GAS - UL-CSA NPT THREAD T16

cim 316.1 GNPT



DN	1/4	3/8	1/2	3/4	1"	1 1/4"	1 1/2"	2"	2 1/2"	3"	4"
Box Cim 16.1 NPT	50	50	40	25	16	10	6	4			
Cart. Cim 16.1 NPT	100	100	160	100	64	40	24	16			
Box Cim 316.1 GNPT	50	50	50	30	20	12	7	4			
Cart. Cim 316.1 GNPT	100	100	200	120	80	48	28	16			



cim 201G FULLWAY BALL VALVE FOR GAS - EN 331 - T10 SERIES

cim 301G

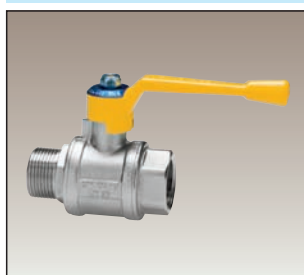

DN	1/4	3/8	1/2	3/4	1"	1 1/4"	1 1/2"	2"
Box Cim 201 G	50	50	25	20	12	6	6	3
Cart. Cim 201 G	100	100	100	80	48	24	24	12
Box Cim 301 G	50	50	35	18	15	8	6	3
Cart. Cim 301 G	100	100	140	72	60	32	24	12

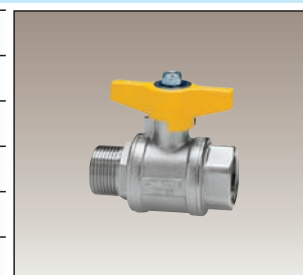

cim 201/12 G FULLWAY BALL VALVE FOR GAS - EN 331 - T12 SERIES

cim 301/12 G

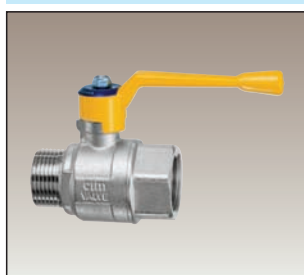

DN	1/4	3/8	1/2	3/4	1"	1 1/4"	1 1/2"	2"
Box Cim 201/12 G	50	50	40	25	18	10	6	3
Cart. Cim 201/12 G	200	200	160	100	72	40	24	12
Box Cim 301/12 G	50	50	40	25	20	10	7	4
Cart. Cim 301/12 G	200	200	160	100	80	40	28	16



cim 201/16 G FULLWAY BALL VALVE FOR GAS - EN 331 - T16 SERIES

cim 301/16 G

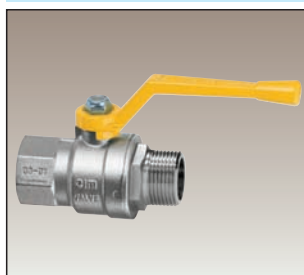

DN	1/4	3/8	1/2	3/4	1"	1 1/4"	1 1/2"	2"
Box Cim 201/16 G			40	25	16	10	6	4
Cart. Cim 201/16 G			160	100	64	40	24	16
Box Cim 301/16 G			50	30	20	10	7	4
Cart. Cim 301/16 G			200	120	80	40	28	16

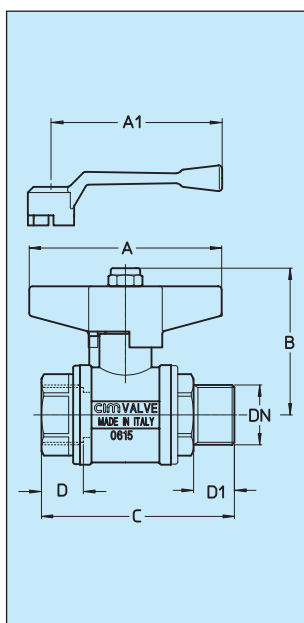
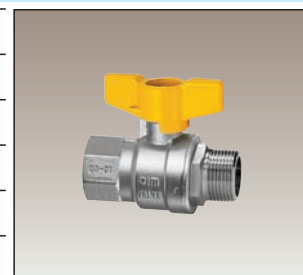

	DN	1/4	3/8	1/2	3/4	1"	1 1/4"	1 1/2"	2"
Cim 16.1 GNPT	Grms.	115	120	185	283	468	725	1086	1645
Cim 17.1 GNPT	A	43	43	55	55	75	75	105	105
	A1	65	65	90	90	110	110	150	150
	B	36	36	49,5	54	63	72	83	90
	C	45	47	55	60	74	81,5	95,5	112,5
	D	11,5	12,5	14	14,5	17	17,5	18	20
Cim 201G	Grms.	185	195	345	630	835	1400	1780	2925
Cim 301G	A	50	50	70	85	85	100	100	100
	A1	80	80	100	120	120	150	150	150
	B	50	50	53	65	69	83	89	96
	C	55,5	57	72	85	96	112	119	144
	D	12,5	13,5	17	18,5	22	24	23	28,5
	D1	12,5	12,5	15,5	18	20,5	23,5	25	28
Cim 201/12G	Grms.	110	110	210	340	545	870	1225	1915
Cim 301/12G	A	43	43	50	70	70	85	100	100
	A1	65	65	80	100	100	120	150	150
	B	36	36	52	56	60	73	89	96
	C	46	47	60	69	80	92	106	124
	D	11,5	12,5	17	18,5	21	22,5	23	26,5
	D1	12,5	12,5	15,5	18	18,5	22	23	26
Cim 201/16G	Grms.	-	-	190	300	505	820	1150	1780
Cim 301/16G	A	-	-	55	55	75	75	105	105
	A1	-	-	90	90	110	110	150	150
	B	-	-	49,5	54	63	72	83	90
	C	-	-	70	76,5	90	106	119	142
	D	-	-	17,5	19	22	25	25	29
	D1	-	-	17	18	21	25	26	29,5



cim 202 G

FULLWAY BALL VALVE FOR GAS - EN 331 - T10 SERIES

cim 302 G

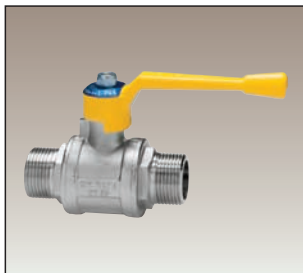

DN	1/4	3/8	1/2	3/4	1"	1 1/4"	1 1/2"	2"
Box Cim 202 G	50	50	25	16	12	6	5	2
Cart. Cim 202 G	100	100	100	64	48	24	20	8
Box Cim 302 G	50	50	35	20	15	8	6	3
Cart. Cim 302 G	100	100	140	80	60	32	24	12

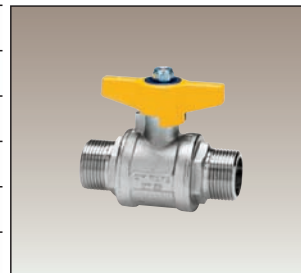

cim 202/12 G

FULLWAY BALL VALVE FOR GAS - EN 331 - T12 SERIES

cim 302/12 G



DN	1/4	3/8	1/2	3/4	1"	1 1/4"	1 1/2"	2"
Box Cim 202/12 G	50	50	25	16	12	6	5	2
Cart. Cim 202/12 G	100	100	100	64	48	24	20	8
Box Cim 302/12 G	50	50	35	20	15	8	6	3
Cart. Cim 302/12 G	100	100	140	80	60	32	24	12



cim 620 G

"FILTRASFERA" - FULLWAY BALL VALVE FOR GAS WITH STRAINER - EN 331 - PATENTED



DN	1/2	3/4	1"
Box	25	15	10
Cart.	100	60	40

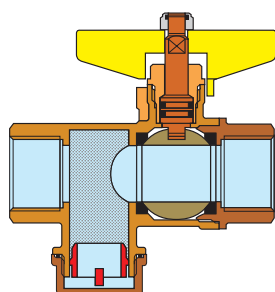
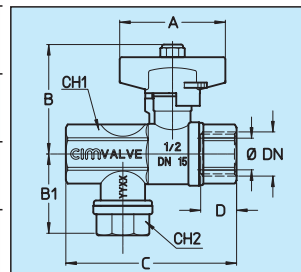

- Self locking nut
- Plate
- Wing handle
- Stem ring
- Stem
- O-Ring
- Body
- Steel
- Aluminium
- EN AB46100
- CW 617N
- CW 617N
- FPM
- CW 617N
- Seat
- Ball
- Plug
- S.S. strainer
- Filter ring
- O-Ring
- Blind plug
- PTFE
- CW 617N
- CW 617N
- Stainless steel
- PPS
- HNBR/75
- CW 617N

cim 620 G

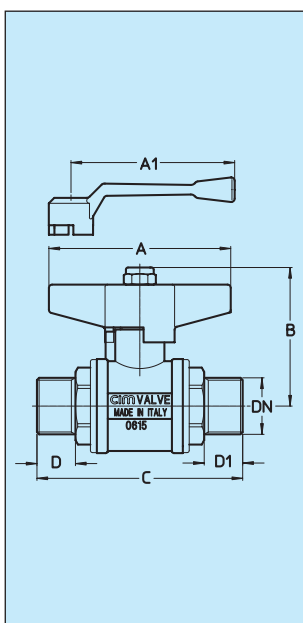

DN	1/4	3/8	1/2	3/4	1"	1 1/4"	1 1/2"	2"
Cim 202 G								
Grms.	190	200	335	655	850	1460	1860	3015
A	50	50	70	85	85	100	100	100
A1	80	80	100	120	120	150	150	150
B	50	50	53	65	69	83	89	96
C	64	64	80	96	105	123	133	158
D	12,5	12,5	15,5	18	20,5	23,5	25	28
D1	12,5	12,5	15,5	18	20,5	23,5	25	28
Cim 202/12 G								
Grms.	110	120	220	345	530	915	1185	1885
A	43	43	50	70	70	85	100	100
A1	65	65	80	100	100	120	150	150
B	36	36	52	56	60	73	89	96
C	55	55	69	77	87	104	116	139
D	11,5	12,5	17	18,5	21	22,5	23	26,5
D1	12,5	12,5	15,5	18	20,5	23,5	25	28
Cim 620 G								
Grms.	-	-	320	520	685	-	-	-
A	-	-	70	70	70	-	-	-
B	-	-	52	56	60	-	-	-
B1	-	-	39	43	50	-	-	-
C	-	-	81	92	112	-	-	-
D	-	-	17	19	21	-	-	-
CH1	-	-	25	31	38	-	-	-
CH2	-	-	25	30	37	-	-	-



cim 229 G

RIGHT ANGLE FULLWAY BALL VALVE FOR GAS - T10 SERIES
FEMALE/FEMALE



DN	1/2x1/2	3/4x3/4	1"x1"
Box	30	18	10
Cart.	120	72	40

cim 230 G

RIGHT ANGLE FULLWAY BALL VALVE FOR GAS - T10 SERIES
FEMALE/MALE



cim 231 G

RIGHT ANGLE FULLWAY BALL VALVE FOR GAS - T10 SERIES
MALE/FEMALE



DN	1/2x1/2	3/4x3/4	1"x1"
Box	30	18	10
Cart.	120	72	40

cim 232 G

RIGHT ANGLE FULLWAY BALL VALVE FOR GAS - T10 SERIES
MALE/MALE



cim 234 G

RIGHT ANGLE FULLWAY BALL VALVE FOR GAS - T12 SERIES
FEMALE/FEMALE



DN	1/2x1/2	3/4x3/4	1"x1"
Box		20	12
Cart.		80	48

cim 235 G

RIGHT ANGLE FULLWAY BALL VALVE FOR GAS - T12 SERIES
FEMALE/MALE



cim 236 G

RIGHT ANGLE FULLWAY BALL VALVE FOR GAS - T12 SERIES
MALE/FEMALE



DN	1/2x1/2	3/4x3/4	1"x1"
Box	35	20	12
Cart.	140	80	48

cim 237 G

RIGHT ANGLE FULLWAY BALL VALVE FOR GAS - T12 SERIES
MALE/MALE



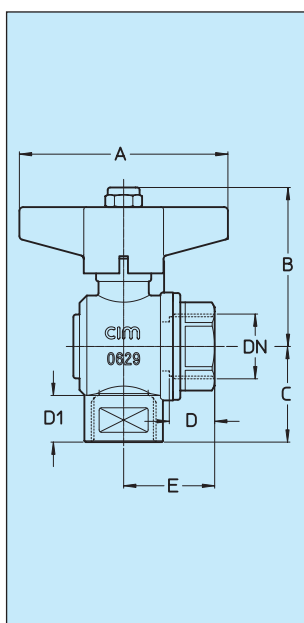

DN	Cim 229 G							Cim 230 G							Cim 231 G							Cim 232 G						
	Grms.	A	B	C	D	D1	E	Grms.	A	B	C	D	D1	E	Grms.	A	B	C	D	D1	E	Grms.	A	B	C	D	D1	E
1/2 x 1/2	265	70	53	35	16	17	31	285	70	53	35	16	17	38,5	265	70	53	35	16	17	31	285	70	53	35	16	17	38,5
3/4 x 3/4	545	85	65	39	18	18	37	565	85	65	39	18	18	48	545	85	65	42	18	18	37	565	85	65	42	18	18	48
1" x 1"	755	85	69	47	22	22	44	780	85	69	47	21	22	52	755	85	69	49	22	22	44	780	85	69	49	21	22	52
DN	Cim 234 G							Cim 235 G							Cim 236 G							Cim 237 G						
	Grms.	A	B	C	D	D1	E	Grms.	A	B	C	D	D1	E	Grms.	A	B	C	D	D1	E	Grms.	A	B	C	D	D1	E
1/2 x 1/2	-	-	-	-	-	-	-	-	-	-	-	-	-	-	210	50	52	35	12,5	15	26	230	50	52	35	17	15	39
3/4 x 3/4	390	70	56	45	19	20	34	390	70	56	45	18	20	42	390	70	56	42	19	17	34	390	70	56	42	18	17	42
1" x 1"	535	70	60	48	21	18	41	520	70	60	48	21	18	49	535	70	60	48	21	18	41	520	70	60	48	21	18	49

cim 27 G

FULLWAY BALL VALVE FOR GAS TO PANEL MOUNT - COVER PLATE Ø 100 - T 10



DN	3/8	1/2	3/4	1"
Box	10	10	10	8
Cart.	40	40	40	32

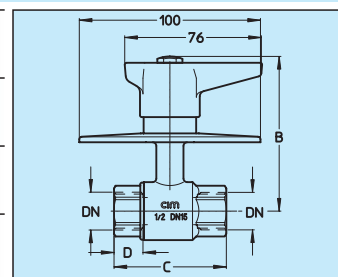

cim 28 G

FULLWAY BALL VALVE FOR GAS TO PANEL MOUNT - COVER PLATE Ø 70 - T 10



DN	3/8	1/2	3/4	1"
Box	10	10	10	8
Cart.	40	40	40	32

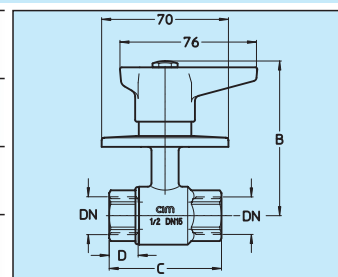

cim 27 GB

"GASBOX" - BUILT - IN KIT FOR GAS TO UNI CIG 7129 - T10

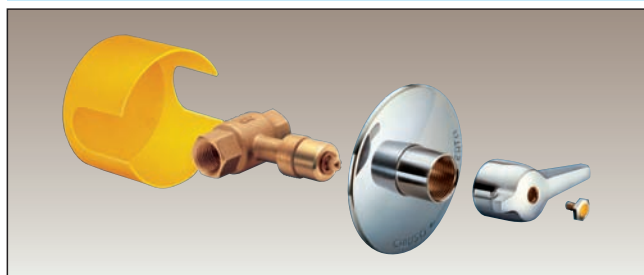

DN	3/8	1/2	3/4
Box	5	5	5
Cart.	20	20	20

cim 27 GB

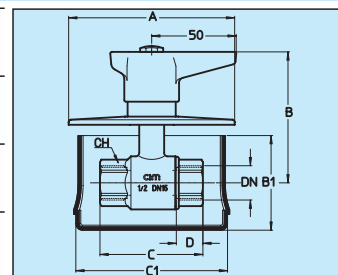

cim 29 GB

"GASBOX 2" - BALL VALVE FOR GAS TO PANEL MOUNT TO UNI - CIG 7129



DN mm	14	16	18
Box	1	1	1
Cart.	10	10	10

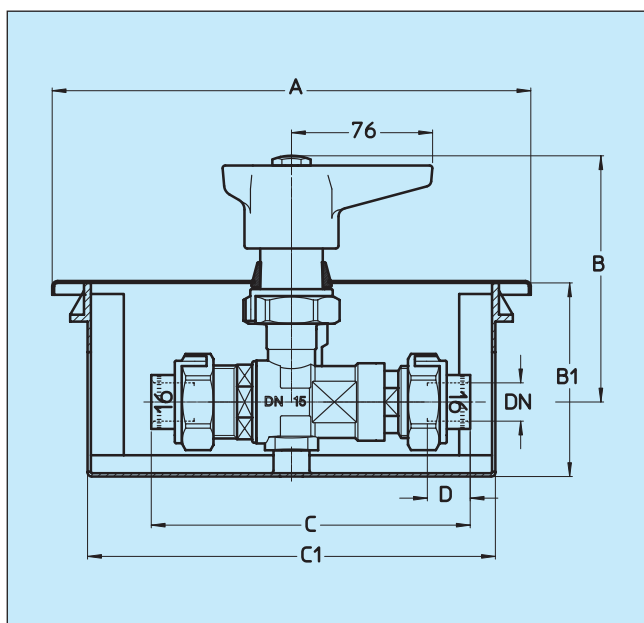
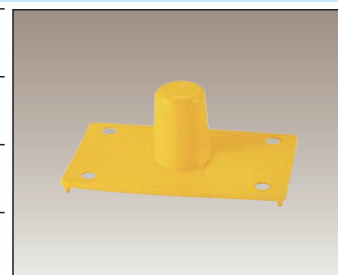

cim 27 G	DN	3/8	1/2	3/4	1"
	Grms.	420	500	740	990
	A	100	100	100	100
	B	77	80	85	88
cim 28 G	DN	3/8	1/2	3/4	1"
	Grms.	420	500	740	990
	A	70	70	70	70
	B	77	80	85	88
cim 27 GB	DN	3/8	1/2	3/4	-
	Grms.	475	555	795	-
	A	100	100	100	-
	B	77	80	85	-
	B1	55	55	55	-
	C	50	62	74	-
	C1	87.5	87.5	87.5	-
	D	13.5	16	18.5	-
	CH	25	25	32	-
	DN	14	16	18	-
cim 29 GB	DN	14	16	18	-
	Grms.	855	852	850	-
	A	173	173	173	-
	B	89	89	89	-
	B1	70	70	70	-
	C	115	115	115	-
C1	147	147	147	-	
D	12	12	12	-	

GASBOX 2



Cim 29 GB "GASBOX 2" is a built-in controllable kit for gas enabling the installation of a built-in type ball valve with capillary ends for gas pipe according to UNI CIG 7129 Standard.

Cim 29 GB "GASBOX 2" is equipped with a safety "push and turn" handle and a protection cover.

In order to facilitate the assembling, GAS BOX 2 is equipped with telescopic joint FURBO series, which eliminates any mistake arising during assembling.

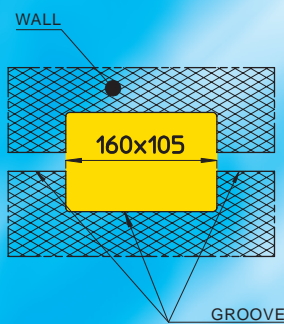
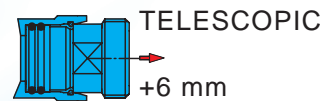

1 PREPARE A SCHEME

Prepare the scheme for pipes and box housing according to UNI 7129 Standard.

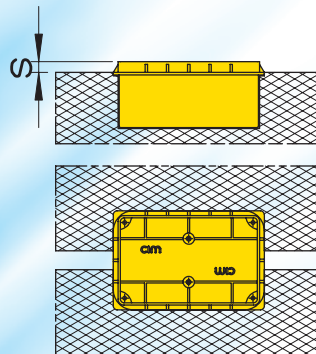

2 BOX FIXING

Assemble all relevant inserts to the box and proceed with the walling, keeping in mind that box should be aligned with the plastered wall.

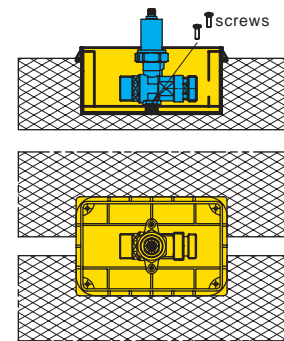

3 ASSEMBLE THE BALL VALVE

Fix the ball valve at the bottom of the box with the suitable screws.

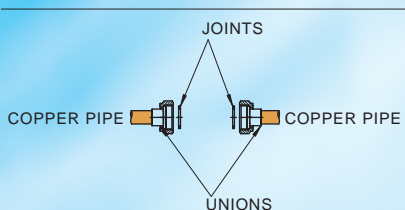

4 CONNECTION TO PIPE

Solder the unions with swivel nut on the pipe ends. Fasten the union, using gaskets between screwed end and union for the head tightness. **IMPORTANT:** Use two spanners, one to tight the union, the other to clamp the valve.

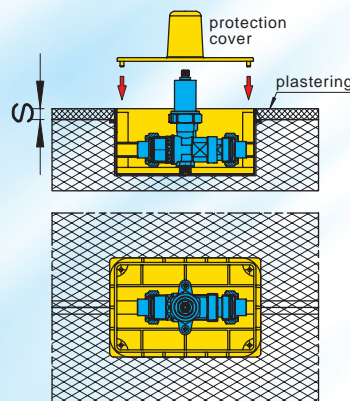

5 WALL THE PIPE

After having tested the tightness of the plant, wall the pipes, using the suitable protecting cover.

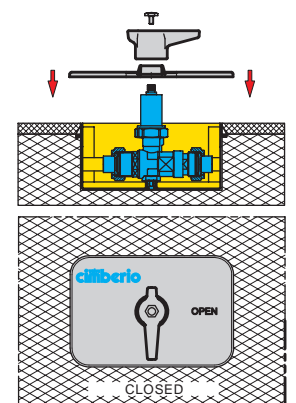

6 PLACE THE WALL-PLATE AND THE HANDLE

Insert the cover on the valve neck. Place the handle and fix it with the suitable screw. **IMPORTANT:** keep the valve closed until the plant activation.

cimfire-safe

BALL VALVES FOR GAS WITH THERMAL RESISTANCE

**FULLWAY BALL VALVE FOR GAS RESISTANCE TO TEMPERATURE 650°C - 30 MIN.
DVGW DIN 3537-1 – ARGB**



cim 802 FP



cim 802 FPF20

FULLWAY BALL VALVE FOR GAS WITH SAFETY THERMAL DEVICE RESISTANCE TO TEMPERATURE 950°C - 60 MIN



cim 12 TAS

SERVICE RECOMMENDATIONS: Ball valves CIM 802FP and CIM 802FPF20 are approved according to DIN EN 331:1999-04 Standard and are suitable for gas at low pressure for the distribution of natural gas, town gas and liquid gas.

The valves are resistant to 650°C temperature for 30 minutes. DN 15 - 20 and 25 are approved by DVGW to DIN 3537-1. All sizes are manufactured in accordance with UNI EN 1775 and are ARGB tested. The handle of CIM 802FPF20 is anti-fraud type by means of a special nut (patent pending) which can be operated only by a specific key.

PRESSURE CLASS: Operating pressure MOP 5

THERMAL RESISTANCE: Temperature up to 650°C - 30 min.

SIZES: DN 15, 20 and 25: operating pressure up to 1 bar, GT 1 DVGW approved to DIN 3537-1

SIZES: DN 32, 40 and 50: operating pressure up to 100 mbar as per ARGB test report.

TEMPERATURE CLASS: -20°C (room temperature from -20°C up to +60°C)

THREADING: female parallel threads to ISO 7/1 Rp

MATERIALS:

- Body, screwed end, ball: hot-pressed from brass bar EN 12165 CW 617 N
- Handle CIM 802FP: brass EN 12165 CW 617 N
- Handle CIM 802FPF20: aluminium EN AB46100

SERVICE RECOMMENDATIONS: Ball valves CIM 12TAS are manufactured in accordance with European Standard EN 331, while the safety thermal device with DIN 3586 Standard. These ball valves are suitable for gas at low pressure for domestic use.

The valve CIM 12TAS combines in one product only the features of a gas ball valve and those of a safety thermal TAS device. This device is automatically activated in case of fire when temperature reaches 100°C so as to prevent a gas leak for 60 minutes at a temperature of 950°C.

PRESSURE CLASS: Operating pressure MOP 5

THERMAL RESISTANCE: Temperature up to 950°C - 60 min. Operating pressure: TAS K - DVGW - GT - PN 4

TEMPERATURE CLASS: -20°C (room temperature from -20°C up to +60°C)

THREADING: Female parallel threads to ISO 7/1 Rp

MATERIALS: Body, ball, handle: hot-pressed from brass bar EN 12165 CW 617 N. TAS connector: steel

GAS BALL VALVE WITH CONIC CONNECTOR RESISTANCE TO TEMPERATURE 650°C - 30 MIN.



cim 800 FP

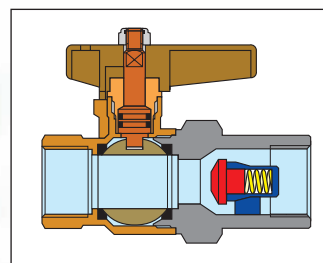

SERVICE RECOMMENDATIONS: Ball valves CIM 800FP are manufactured in accordance with European Standard EN 331 and are suitable for gas at low pressure. They are recommended for flexible connections on gas appliances such as for instance brass and wall boilers.

PRESSURE CLASS: Operating pressure MOP 5

THERMAL RESISTANCE: Temperature up to 650°C - 30 min.; operating pressure up to 100 mbar as per ARGB test report.

TEMPERATURE CLASS: -20°C (room temperature from -20°C up to +60°C)

THREADING: Female parallel threads to ISO 7/1 Rp

MATERIALS: Body, conic connector, ball, handle: hot-pressed from brass bar EN 12165 CW 617N.

cim 802 FP

FULLWAY BALL VALVE FOR GAS - EN 331 - T12 SERIES
ARGB DIN DVGW APPROVAL - HTB 650°C - 30 MIN.



DN	1/2	3/4	1"	1 1/4"	1 1/2"	2"
Box	25	16	12	6	5	3
Cart.	100	64	48	24	20	12

cim 801 FP



cim 802 PPF20

FULLWAY BALL VALVE FOR GAS-EN 331-T12 - TAMPER PROOF HANDLE
ARGB DIN DVGW APPROVAL- HTB 650°C - 30 MIN.



DN	1/2	3/4	1"
Box	20	15	10
Cart.	80	60	40

cim 801 PPF20



cim 800 FP

BALL VALVE FOR GAS WITH FEMALE UNION JOINT
ARGB APPROVAL HTB 650° - 30 MINUTES



DN	1/2	3/4
Box	30	20
Cart.	120	80

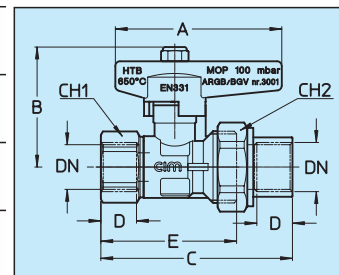

cim 12 TAS

FULLWAY BALL VALVE FOR GAS WITH SAFETY THERMAL DEVICE
RESISTANCE TO TEMPERATURE 950° FOR 60 MINUTES - T12 SERIES



DN	1/2	3/4	1"
Box	20	15	10
Cart.	80	60	40

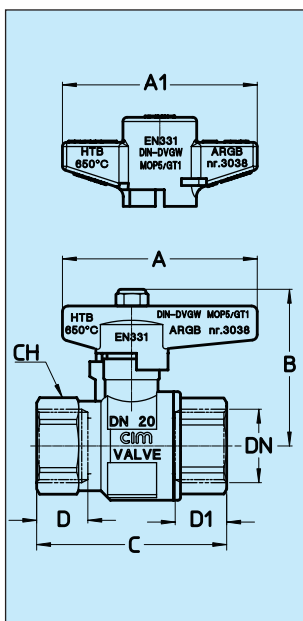
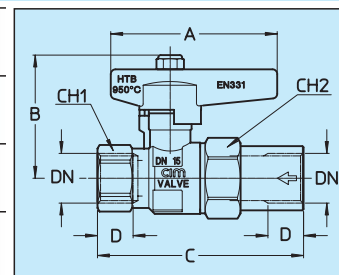

		Cim 802 FP - Cim 802 PPF20								Cim 801 FP - Cim 801 PPF20								
DN	Grms.	A	A1	B	C	D	D1	CH	nr.ARGB/BGV	Grms.	A	A1	B	C	D	D1	CH	nr.ARGB/BGV
1/2	262	70	70	52	61	17	17	25	nr. 3037	275	70	70	52	69	17	17	25	nr. 3037
3/4	392	70	70	56	69	18,5	18,5	31	nr. 3038	400	70	70	56	76	18,5	18	31	nr. 3038
1"	638	70	70	60	82	21	21	40	nr. 3039	628	70	70	60	90	21	21	40	nr. 3039
1 1/4"	989	90	85	73	92	22,5	22,5	49	nr. 3040	1040	90	85	73	103	22,5	25	49	nr. 3040
1 1/2"	1614	105	100	89	107	23	23	55	nr. 3041	1587	105	100	89	117	23	26	55	nr. 3041
2"	2549	105	100	96	125	26,5	26,5	69	nr. 3042	2540	105	100	96	139	26,5	30	69	nr. 3042
		Cim 12 TAS								Cim 800 FP								
DN	Grms.	A	B	C	D	D1	CH1	CH2	nr.ARGB/BGV	Grms.	A	B	C	D	D1	CH1	CH2	nr.ARGB/BGV
1/2	375	70	52	87	17	15	25	30	-	350	70	51	81	15	15	27	34	nr. 3000
3/4	565	70	56	99	18,5	16,5	31	40	-	465	70	52	99	16,3	16,3	32	41	nr. 3001
1"	960	70	60	115	21	19,1	21	50	-	-	-	-	-	-	-	-	-	-



FULLWAY BALL VALVE FOR GAS WITH PRESSFITTINGS

cimpress[®] gas

PATENTED

SERVICE RECOMMENDATIONS:

The CIMPRESS gas ball valves are purposely designed for direct connection to copper pipe using standard cold pressure press tools. These are manufactured and certified to UNI 11065 and EN 331, and are suitable for gas at low pressure for the distribution of natural gas, town gas and liquid gas.

Quick

CIMPRESS valves ensure fast installation with press connection using standard press tools.

Safety

CIMPRESS valves do not need welding or brazing and consequently avoid any fire risk or damage.

Two O'Rings ensure a double tightness against possible leakage.
DZR brass "CR" gives added protection against possible corrosion.

Cost effective

CIMPRESS valve incorporates valve and pressfittings, reducing the needed components and labour costs.

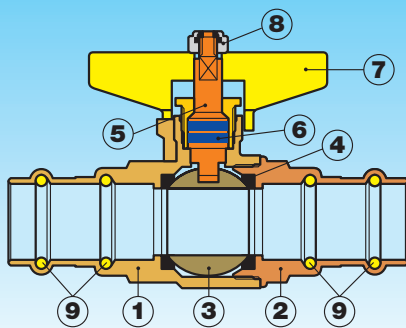

Components

- 1 Body
- 2 Screwed end
- 3 Ball
- 4 Ball gaskets
- 5 Stem
- 6 Stem gaskets
- 7 Handle
- 8 Self lock nut
- 9 Seal rings

Materials

1	Body	"CR" brass EN 12165 CW 602 N
2	Screwed end	"CR" brass EN 12165 CW 602 N
3	Ball	"CR" brass EN 12165 CW 602 N
4	Ball gaskets	P.T.F.E.
5	Stem	"CR" brass EN 12165 CW 602 N
6	Stem gaskets	N.B.R.
7	Handle	EN AB 46100
8	Self lock nut	Steel
9	Seal rings	H.N.B.R.

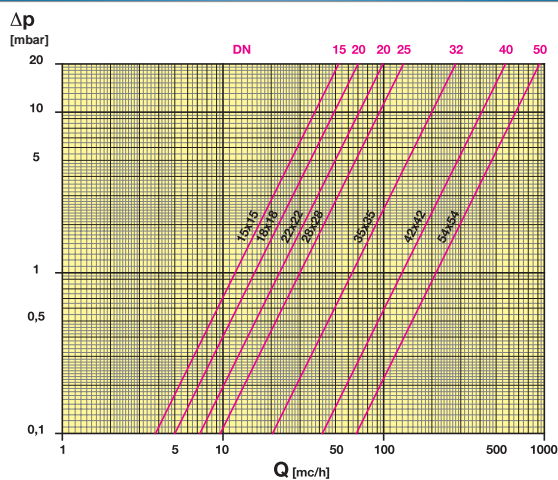

FLOW AND PRESSURE DROP



KV CM CS MT

	KV	CM	CS	MT			
Ø PFT	15X15	18X18	22X22	28X28	35X35	42X42	54X54
Ø mm.	15	20	20	25	32	40	50
KV	12	16	23	30	65	131	214
CM	3	4	4	5	8	10	13
CS	6	10	10	12	17	22	26
MT	18	28	28	28	42	80	80

	IMO S.p.A. I-20138 Milano - via Quinlano, 43 Tel. 025073101(a) - fax 0250691500 e-mail: info@img.it - www.img.it	Rea Milano 1595884 Registro Imprese MI 12896410159 C.F./P.I. 12896410159 Capitale Sociale € 4.000.000 SN.I0006X	CA06.00220
IMP: 06402200 COD: CN.H0007W	Certificato di approvazione <i>Approval certificate</i>		
IMO, ente di certificazione accreditato, autorizza la ditta <i>IMO, accredited certification body, grants to authorize the ditta</i>			
CAV. UFF. GIACOMO CIMBERIO SPA VIA TORCHIO 57 28017 SAN MAURIZIO D'OPAGLIO NO			
all'uso del marchio <i>the licence to use the mark</i>			
IMQ-UNICIG			
			
per i seguenti prodotti Valvole manuali a sfera con raccordi a pressare/filettati (Tipo CIMPRESS GAS T 220G)		for the following products Manually ball valves with press/threaded fittings (Type CIMPRESS GAS T 220G)	
<p><small>This certificate is subject to the conditions foreseen by "IMQ Rules - Product Certification" and is relevant to the products listed in the annex to this certificate.</small></p> <p>Emesso il / Issued on: 2008-02-15 Data di aggiornamento / Updated on: _____ Sostituisce / Replaces: _____</p> <p><i>Mario Romano</i> IMQ S.p.A.</p>			

	IMO S.p.A. I-20138 Milano - via Quinlano, 43 Tel. 025073101(a) - fax 0250691500 e-mail: info@img.it - www.img.it	Rea Milano 1595884 Registro Imprese MI 12896410159 C.F./P.I. 12896410159 Capitale Sociale € 4.000.000 SN.I0006X	CA06.00220
Allegato - Certificato di approvazione <i>Annex - Approval certificate</i>		Emesso il / Issued on: 2008-02-15 Data di aggiornamento / Updated on: _____ Sostituisce / Replaces: _____	
Prodotto / Product Valvole manuali a sfera con raccordi a pressare/filettati Manually ball valves with press/threaded fittings			
Concessionario / Licence Holder CAV. UFF. GIACOMO CIMBERIO SPA VIA TORCHIO 57 28017 SAN MAURIZIO D'OPAGLIO NO		Marchio / Mark 	
Costruito a / Manufactured at			
28017 SAN MAURIZIO D'OPAGLIO		NO Italy	
28076 POGNO		NO Italy	
<p><small>Copia del presente certificato deve essere conservata presso i luoghi di produzione</small> <i>Copy of this certificate must be available at the manufacturing places listed above upon request.</i></p>			
Norme Capitolato Tecnico IMQ CPT-059 / Ed. 2006		Standards Test Specifications IMQ CPT-059 / Ed. 2006	
Rapporti / Test Reports 06AH00390			
Caratteristiche tecniche / Technical characteristics			
Tipo di prodotto / Product: Valvole manuali a sfera per gas/Manually ball valves for gas			
Serie / Series: Tipo/Type CIMPRESS GAS T 220G			
Classe di pressione / Pressure class: MOP 5/GT1			
Temperatura di esercizio / Working temperature: Da/From -20 °C a/to +60 °C			
Guarnizione di tenuta / O-ring seal: HNBR giallo/yellow (*)			
Articoli (con dettagli) / Articles (with details)			
46.000.0			
Marca / Trade mark: CIMBERIO		Modello / Model: CIM 220G	
Raccordo di entrata a pressione / Inlet press fitting: CIMPRESS		Raccordo di uscita a pressione / Outlet press fitting: CIMPRESS	
Materiale / Material: Ottone/Brass		Diametro nominale / Rated diameter: 15 mm; 18 mm; 22 mm; 28 mm; 35 mm; 42 mm; 54 mm	
46.000.1			
Marca / Trade mark: CIMBERIO		Modello / Model: CIM 220GL	
Raccordo di entrata a pressione / Inlet press fitting: CIMPRESS		Raccordo di uscita a pressione / Outlet press fitting: CIMPRESS	
Materiale / Material: Ottone/Brass		Diametro nominale / Rated diameter: 15 mm; 18 mm; 22 mm; 28 mm; 35 mm; 42 mm; 54 mm	
46.000.2			
Marca / Trade mark: CIMBERIO		Modello / Model: CIM 220GL	
Raccordo di entrata a pressione / Inlet press fitting: CIMPRESS		Raccordo di uscita a pressione / Outlet press fitting: CIMPRESS	
Materiale / Material: Ottone/Brass		Diametro nominale / Rated diameter: 15 mm; 18 mm; 22 mm; 28 mm; 35 mm; 42 mm; 54 mm	
46.000.3			
Marca / Trade mark: CIMBERIO		Modello / Model: CIM 220G	
Raccordo di entrata a pressione / Inlet press fitting: CIMPRESS		Raccordo di uscita a pressione / Outlet press fitting: CIMPRESS	
Materiale / Material: Ottone/Brass		Diametro nominale / Rated diameter: 15 mm; 18 mm; 22 mm; 28 mm; 35 mm; 42 mm; 54 mm	

5001 East Philadelphia Street, Ontario, California 91761-2816 • (909) 472-4100 Fax (909) 472-4244 • www.lapmo.com

CERTIFICATE OF LISTING

IAPMO Research and Testing, Inc. is a product certification body which tests and inspects samples taken from the supplier's stock or from the market or a combination of both to verify conformance to the requirements of applicable codes and standards. This activity is conducted with periodic surveillance of the supplier's factory and laboratories as well as the assessment of the supplier's Quality Assurance System. This listing is subject to the conditions set forth in the IAPMO Uniform Plumbing Code and is not to be construed as any recommendation, assurance or guarantee by IAPMO Research and Testing, Inc. of the product acceptance by Authorities Having Jurisdiction.

Effective Date: December 2007 *Void After: December 2009*

Product: Ball Valves *File No.: 4704*

Issued To: CAV. UFF. GIACOMO CIMBERIO S.p.A.
Via Torchio, 57
San Maurizio D'Opaglio, (NO)
28017, ITALY

IDENTIFICATION: Each ball valve shall bear permanent legible markings of the manufacturer's name or trademark, valve size, rated working pressure, ANSI NSF 61/FP (for handle or body) if rated for potable drinking water service, "Steam" and rated working pressure if rated for steam service, "RP" on body (for reduced port valves that do not meet full flow requirements of Table 1 in UPC 157), "Cold Only" for valves intended for cold water service only, and the UPC certification mark.

CHARACTERISTICS: Ball valves to be installed with other IAPMO R&T listed fittings, in accordance with the manufacturer's instructions and the requirements of the latest edition of the Uniform Plumbing Code. Products comply with the applicable sections of the latest edition of the Uniform Plumbing Code. Manufactured in compliance with IPC 153-2007. Products listed on this certificate have been tested by an IAPMO R&T recognized laboratory. This recognition has been granted based upon the laboratory's compliance to the applicable requirements of ISO/IEC 17025.

Note: The following models are in compliance with NSPS, Section 8

Model No.	Size
CIM 220.I	1/2", 3/4", 1"
CIM 220.II	1-1/4", 1-1/2", 2"

Robert R. Simmer Chairman, Product Certification Committee
Ren Chaney Executive Director



This listing is for the period indicated herein and is void after the date shown above. Any change in material, manufacturing process, marking or design without having first obtained the approval of the Product Certification Committee, or any evidence of non-conformance with applicable codes and standards or of inferior workmanship, may be deemed sufficient cause for revocation of this listing. Reproduction of or reference to this listing for advertising purposes may be made only by specific written permission of IAPMO Research and Testing, Inc. Any alteration of this certificate could be grounds for revocation of the listing.

ARGB - KVBG

The ARGB-KVBG laboratory certifies the conformity with the Belgian requirements for gas valves with MOP ≤ 100 mbar
Le laboratoire de l'ARGB certifie que les robinets avec une pression de service < 100 mbar sont conformes aux exigences Belges.
Het laboratorium van de KVBG verklaart dat de gasranen met bedrijfsdruk < 100 mbar conform zijn aan de Belgische eisen

Certificate number: 3234
N° du certificat / Certificatnummer: 3234

Date of issue: 20-05-2006
Date d'édition / Datum van aflevering: 20-05-2006

Expiry date: 20-05-2006 "prolongé 2010"
Date d'échéance / Geldig tot: 20-05-2006 "prolongé 2010"

Manufacturer: CAV. UFF. GIACOMO CIMBERIO S.p.A.
Fabricant / Fabrikant: Via Torchio 57, 28017 San Maurizio d'Opaglio (NO) ITALY

Vanne type: Straight gas ball valve with press fitting ends
Valve Model: Vanne droite à tournant sphérique à embouts à sertir
Kraan type: Rechte bolkraan met pers eindstukken
CIMBERIO model CIMPRESS figure 220FP
15 x 15; 18 x 18; 22 x 22; 28 x 28

Exigences belges / Belgian Requirements / Belgische eisen:

- Conformity to EN 331 "Manually operated ball valves and closed bottom taper plug valves for gas installations for buildings."
- Conforme à la norme EN 331 « Robinets à tournant sphérique et robinets à tournant conique à fond plat destinés à être manœuvrés manuellement et à être utilisés pour les installations de gaz des bâtiments »
- Conform to norm EN 331 « handbediende bolkransen en conische plugkransen met platte bodem bestemd voor gasinstallaties in gebouwen »
- test report "Laboratorio prove gas IMG" report n° 06SE000602
- high temperature resistance according to EN 1775 annex A clause 2
- résistance aux hautes températures suivant la EN 1775 annexe A procédure B
- weerstand tegen de hoge temperatuur volgens EN 1775 bijlage A procedure B
- test report KVBG/ARGB report n° 3234-3235
- Conformity to UNI 11065 "Copper and copper alloys fittings with press-ends for water and gas - minimal requirements"
- Conformité à la norme UNI 11065 « Cuivre et alliages de cuivre avec embouts à sertir - exigences minimales »
- Conformiteit volgens norm UNI 11065 "Koper en koperlegeringen met pers-einden - minimale eisen"
- test report "Laboratorio prove gas IMG" report n° 06SE000601

Responsible testing gas accessories
Responsable essais accessoires gaz
Verantwoordelijke testen gas hulpstukken

Bart THOMAS

ARGB-KVBG - Rodestraat 125 - BE - 1630 Linkebeek
Phone: +32.02.383.02.00 - Fax: +32.02.380.87.04 - E-mail: kvb@kvbgb.be or argb@argb.be / www.gasinfo.be

cim 220 G

cimpress gas "CR" PRESSFITTINGS BALL VALVE - PRESS/PRESS

cim 220 GL

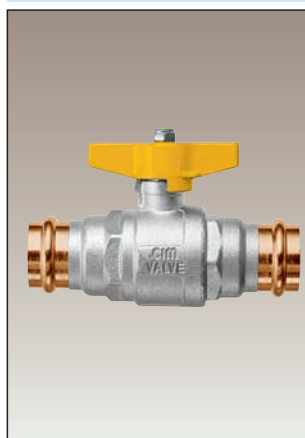

DN	15x15	18x18	22x22	28x28	35x35	42x42	54x54
Ø mm	15	18	22	28	35	42	54
Box Cim 220 G	30	20	20	15	8	6	3
Box Cim 220 GL	30	20	20	15	8	6	3
Grms.	270	400	440	620	940	1400	2060
A	50	70	70	70	85	100	100
A1	80	100	100	100	120	150	150
B	52	56	56	60	72,5	88,5	95,5
C	107	114,5	120	127,5	133,5	155	182
D	39,8	41,3	44	44	43	48	54

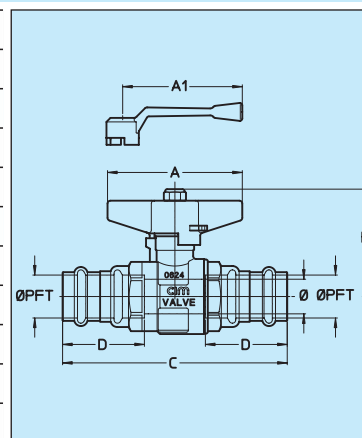

cim 221 G

cimpress gas "CR" PRESSFITTINGS BALL VALVE - FEMALE/PRESS

cim 221 GL



DN	1/2x15	3/4x18	3/4x22	1"x28	1 1/4"x35	1 1/2"x42	2"x54
Ø PTF	15	18	22	28	35	42	54
Box Cim 221 G	30	20	20	15	8	6	3
Box Cim 221 GL	30	20	20	15	8	6	3
Grms.	250	380	400	600	925	1360	2030
A	50	70	70	70	85	100	100
A1	80	100	100	100	120	150	150
B	52	56	56	60	72,5	88,5	95,5
C	83,5	91,5	94,5	105	112,5	131	152,5
D	39,8	41,3	44	44	43	48	54
D1	17	18,5	18,5	21	22,5	23	26,5

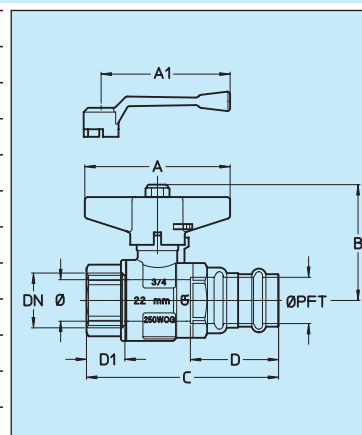

cim 222 G

cimpress gas "CR" PRESSFITTINGS BALL VALVE - MALE/PRESS

cim 222 GL



DN	1/2x15	3/4x18	3/4x22	1"x28	1 1/4"x35	1 1/2"x42	2"x54
Ø PTF	15	18	22	28	35	42	54
Box Cim 222 G	30	20	20	15	8	6	3
Box Cim 222 GL	30	20	20	15	8	6	3
Grms.	250	380	400	600	960	1335	2000
A	50	70	70	70	85	100	100
A1	80	100	100	100	120	150	150
B	52	56	56	60	72,5	88,5	95,5
C	92	99,5	102	112,5	124	141	167
D	39,8	41,3	44	44	43	48	54
D1	17	18	18	21	25	26	29,5

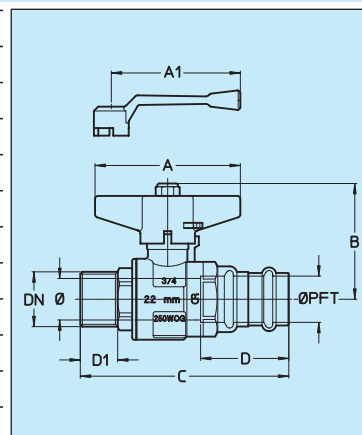

cim 220 FP

cimpress gas "CR" PRESSFITTINGS BALL VALVE - PRESS/PRESS - HTB 650°C - 30 MIN.



DN	15x15	18x18	22x22	28x28	35x35	42x42	54x54
Ø PTF	15	20	20	25	32	40	50
Box	30	20	20	15	6	4	2
Grms.	300	430	470	620	995	1485	2150
A	70	70	70	70	90	105	105
B	52	56	56	60	72,5	88,5	95,5
C	107	114,5	120	127,5	133,5	155	182
D	39,8	41,3	44	44	43	48	54

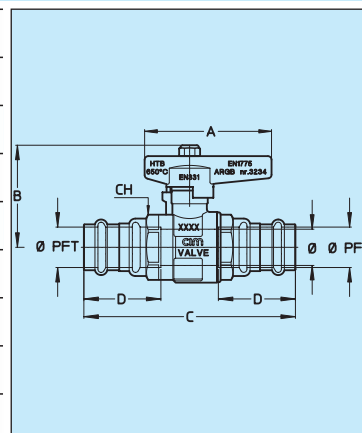

cim 221 FP

cimpress gas "CR"
PRESSFITTINGS BALL VALVE - FEMALE/PRESS - HTB 650°C - 30 MIN.



DN	1/2x15	3/4x18	3/4x22	1"x28	1 1/4"x35	1 1/2"x42	2"x54
Ø PTF	15	18	22	28	35	42	54
Box	30	20	20	15	6	4	2
Grms.	280	415	435	630	1040	1535	2255
A	70	70	70	70	90	105	105
B	52	56	56	60	72,5	88,5	95,5
C	83,5	91,5	94,5	105	112,5	131	152,5
D	39,8	41,3	44	44	43	48	54
D1	17	18,5	18,5	21	22,5	23	26,5

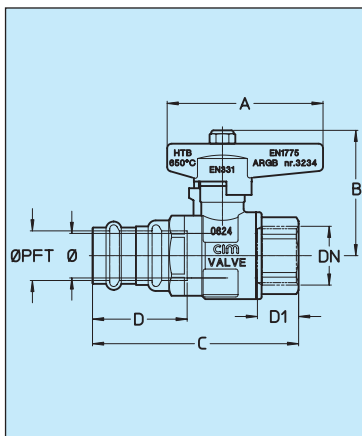

cim 222 FP

cimpress gas "CR"
PRESSFITTINGS BALL VALVE - MALE/PRESS - HTB 650°C - 30 MIN.



DN	1/2x15	3/4x18	3/4x22	1"x28	1 1/4"x35	1 1/2"x42	2"x54
Ø PTF	15	18	22	28	35	42	54
Box	30	20	20	15	6	4	2
Grms.	285	415	435	615	1050	1460	2220
A	70	70	70	70	90	105	105
B	52	56	56	60	72,5	88,5	95,5
C	92	99,5	102	112,5	124	141	167
D	39,8	41,3	44	44	43	48	54
D1	17	18	18	21	25	26	30

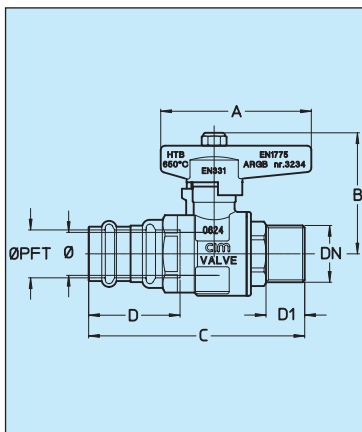

cim 215 G

cimpress gas
RIGHT ANGLE BALL VALVE FEMALE/PRESS



DN	-	3/4x18	3/4x22	1"x28	-	-	-
Ø PTF	-	18	22	28	-	-	-
Box	-	20	18	10	-	-	-
Grms.	-	410	425	560	-	-	-
A	-	70	70	70	-	-	-
B	-	56	56	60	-	-	-
B1	-	45	45	50,5	-	-	-
D	-	41,3	44	44	-	-	-
D1	-	20	20	21	-	-	-
E	-	57	60	64	-	-	-

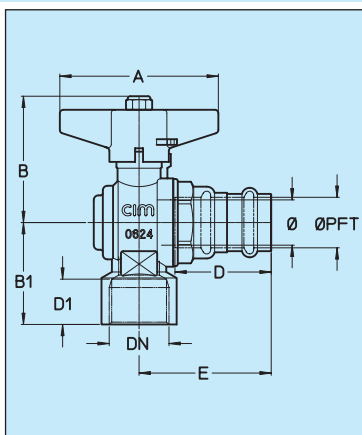

cim 216 G

cimpress gas
RIGHT ANGLE BALL VALVE MALE/PRESS



DN	1/2x15	3/4x18	3/4x22	1"x28	-	-	-
Ø PTF	15	18	22	28	-	-	-
Box	35	20	18	10	-	-	-
Grms.	285	380	400	560	-	-	-
A	50	70	70	70	-	-	-
B	52	56	56	60	-	-	-
B1	35	42	42	48	-	-	-
D	39,8	41,3	44	44	-	-	-
D1	15	17	17	18	-	-	-
E	53	57	60	64	-	-	-

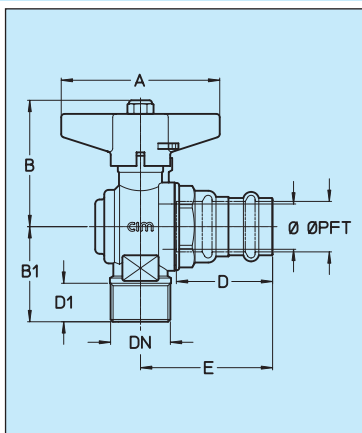

cim 12 GSI

FULLWAY BALL VALVE FOR GAS WITH LOCKABLE HANDLE - AUTOMATIC LOCKING DEVICE - OPEN/CLOSED



DN	1/2	3/4	1"
Box	20	15	10
Cart.	80	60	40

cim 115 G

FULLWAY BALL VALVE FOR GAS WITH KEY-OPERATED AUTOMATIC LOCKING HANDLE - OPEN/CLOSED



DN	3/4	1"
Box	10	10
Cart.	40	40

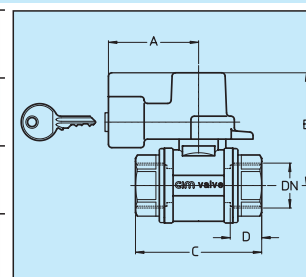

cim 116 G

FULLWAY BALL VALVE FOR GAS WITH SWIVEL UNION FOR NATURAL GAS METER



DN	3/4x1 1/4"	1"x1 1/4"
Box	15	20
Cart.	60	80

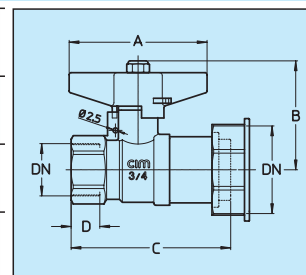

cim 118 G

FULLWAY BALL VALVE FOR GAS WITH SWIVEL UNION FOR METER CONNECTION AND KEY-OPERATED AUTOMATIC LOCKING HANDLE



DN	3/4x1 1/4"	1"x1 1/4"
Box	10	8
Cart.	40	32

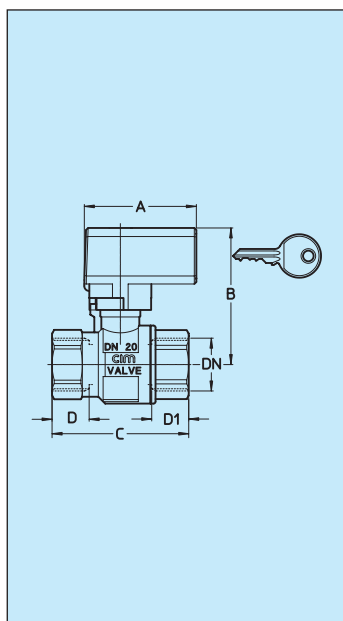
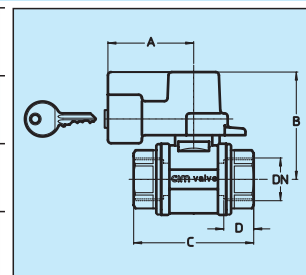

DN	Cim 12 GSI						Cim 115 G				
	Grms.	A	B	C	D	D1	Grms.	A	B	C	D
1/2	400	56	64	61	17	17	-	-	-	-	-
3/4	530	56	68	68	18,5	18,5	765	56	66	74	18,5
1"	775	56	72	82	21	21	930	56	70	88	22
DN	Cim 116 G						Cim 118 G				
	Grms.	A	B	C	D	D1	Grms.	A	B	C	D
3/4x1 1/4	470	70	55	75	17	11,5	915	56	66	82	18,5
1"x1 1/4	510	70	56	78	21	10	1140	56	66	85	22

cim 119 G

RIGHT ANGLE FULLWAY BALL VALVE FOR GAS WITH KEY OPERATED AUTOMATIC LOCKING HANDLE



PHASING OUT

DN	3/4	1"
Box	-	10
Cart.	-	40

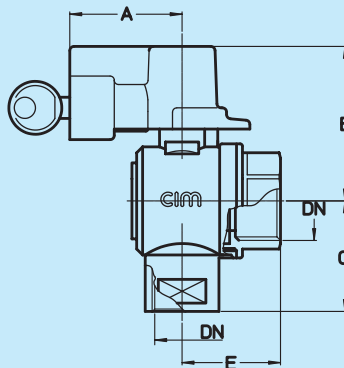

DN	1"
Grms.	930
A	56
B	70
C	47
E	44

cim 119 GC

FULLWAY BALL VALVE FOR GAS WITH SWIVEL UNION FOR METER CONNECTION AND KEY OPERATED



PHASING OUT

DN	3/4x1 1/4"	1"x1 1/4"
Box	-	10
Cart.	-	40

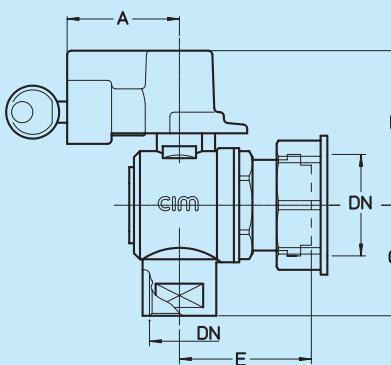

DN	1"x1 1/4"
Grms.	1050
A	56
B	70
C	47
E	60

cim 233 G

RIGHT ANGLE FULLWAY BALL VALVE FOR NATURAL GAS METER



DN	3/4x1 1/4"	1"x1 1/4"
Box	-	10
Cart.	-	40

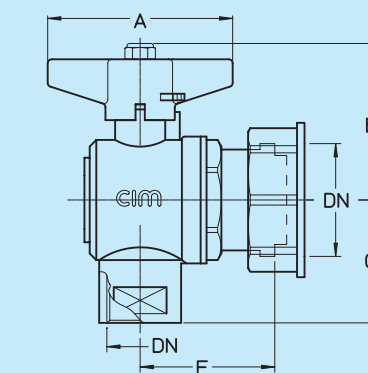

DN	1"x1 1/4"
Grms.	870
A	85
B	70
C	47
E	60

cim 117 G

WALL BRACKET (110 mm) FOR METER WITH BALL VALVE FOR GAS



DN	3/4x1 1/4"	1"x1 1/4"
Box	8	8
Cart.	32	32

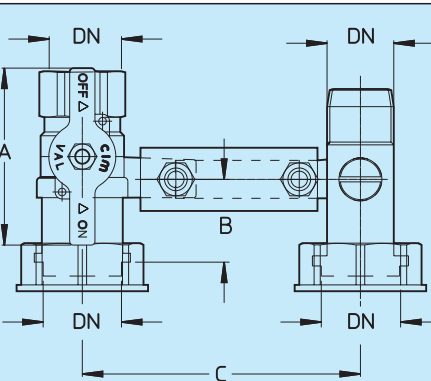

DN	3/4"x1 1/4"	1"x1 1/4"
Grms.	890	975
A	70	70
B	32,5	32,5
C	110	110

cim 117 G2

WALL BRACKET (110mm) FOR METER WITH BALL VALVE FOR GAS



DN	3/4x1 1/4"	1"x1 1/4"
Box	5	5
Cart.	20	20

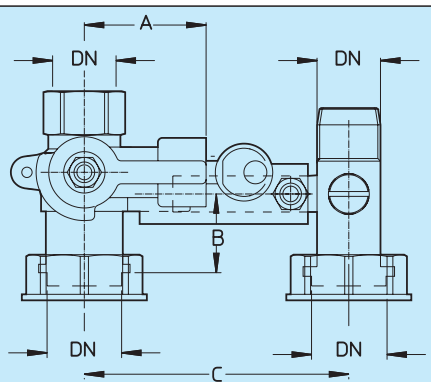

DN	3/4"x1 1/4"	1"x1 1/4"
Grms.	1310	1345
A	56	56
B	32,5	32,5
C	110	110



cim 410 G

T10

FULLWAY BALL VALVE FOR GAS - FOR RISER

T12

cim 411 G



DN	3/4"	1"	1 1/4"	1 1/2"	2"	2 1/2"	3"
Box	20	15	10	6	3	2	2
Cart.	80	60	40	24	12	8	8
Box	20	15	10	6	4		
Cart.	80	60	40	24	16		

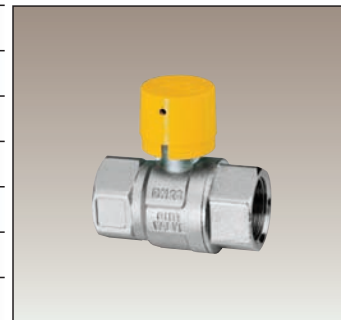

cim 415

FULLWAY BALL VALVE WITH ISOLATING JOINT - T12

cim 416



DN	3/4"	1"	1 1/4"	1 1/2"	2"	2 1/2"	3"
Box	10	8	5	3	2		
Cart.	40	32	20	12	8		



SERVICE RECOMMENDATIONS:

- water, oil, gas plants;
- the compartmentalization of pipelines into distinct areas; inhibits the free flow of harmful electric currents;
- cathodic protection is ensured for the individual users specific requirement;
- the consumers connection provide insulation between the users plant or machinery and the main supply.

ADVANTAGES:

- the elimination or a significant reduction of corrosive damage; thus ameliorating interruption of flow; extra maintenance costs and media contamination;
- a considerable saving in both costs and installation time together with the perfect tightness that is assured by the mono-bloc construction i.e. ball valve and isolating joint in one unit;

- the saving of maintenance costs due to the cathodic protection provided by this unique product.

MECHANICAL PROPERTIES:

- resistance in air: over 5 Mohm;
- testing voltage: over 3.000 V - 50 Hz;
- hydraulic test pressure: 1,5 x PN;
- working temperature: up to 70°C;
- resistance (water at full flow) is by the following formula:

$$R = \rho \frac{L - (2x)}{S} \text{ Ohm}$$

(R = Ohm; L = length of joints in cm.; x = length of joint, not internally covered with insulation, in mm.; S = cross sectional area of joint in cm² through which the product passes; ρ = resistivity of water in Ohm . cm.)

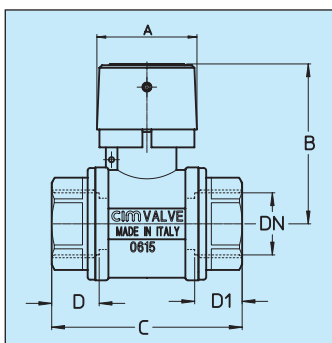

		Cim 410 G						Cim 411 G					
DN	Grms.	A	B	C	D	D1	Grms.	A	B	C	D	D1	
3/4"	610	39	61	74	18,5	18,5	405	39	58	68	18,5	18,5	
1"	840	39	65	88	22	22	640	39	62	82	21	21	
1 1/4"	1315	46	80	101	24	24	920	39	70	92	22,5	22,5	
1 1/2"	1705	46	85	105	23	23	1560	46	85	106,5	23	23	
2"	2930	46	92	130	28,5	28,5	2040	46	92	124,5	26,5	26,5	
2 1/2"	6510	62	126	158	31	31	-	-	-	-	-	-	
3"	9960	62	145	183	35	35	-	-	-	-	-	-	

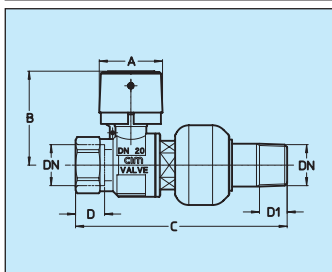

		Cim 415					Cim 416					
DN	Grms.	A	B	C	D	D1	Grms.	A	B	C	D	D1 Ø
3/4"	770	39	58	132	18,5	20	840	39	58	187	18,5	26,9
1"	1130	39	62	144	21	20	1295	39	62	206	21	33,7
1 1/4"	1505	39	70	170	22,5	22	1765	39	70	232	22,5	42,4
1 1/2"	2245	46	85	184	23	22	2240	46	85	250	23	48,3
2"	3290	46	92	191	26,5	22	3500	46	92	271	26,5	60,3

cim 011 G

MINI BALL VALVE FOR GAS

cim 012 G



DN	1/4	3/8	1/2	
Box	50	50	50	
Cart.	200	200	200	



cim 185

RIGHT ANGLE BALL BIB COCK FOR BOILERS

cim 186



DN		1/2x1/2	1/2x3/4	
Box		10	10	
Cart.		100	100	



cim 187

STRAIGHT BALL BIB COCK FOR BOILERS

cim 188

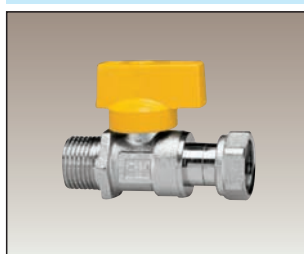

DN		1/2x1/2	1/2x3/4	
Box		10	50	
Cart.		100	150	

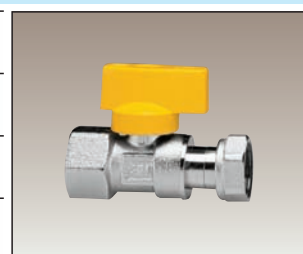

cim 185 S

RIGHT ANGLE BALL BIB COCK FOR BOILERS MALE/SWIVEL NUT



DN	1/2x1/2 Ø 9	1/2x3/4 Ø 9	1/2x3/4 Ø 15	3/4x3/4 Ø 15
Box	10	10	10	20
Cart.	40	40	40	80

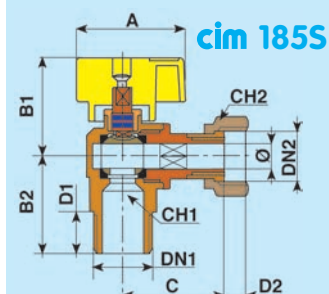
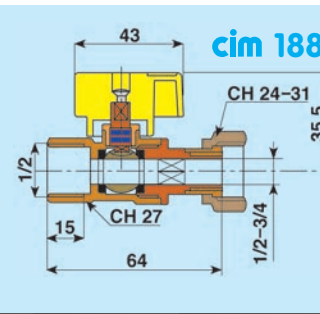
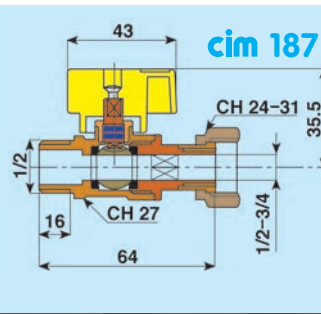
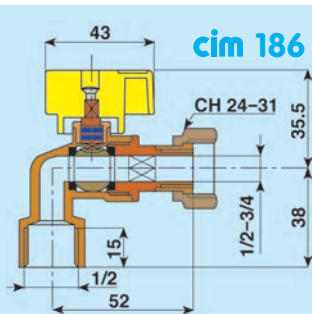
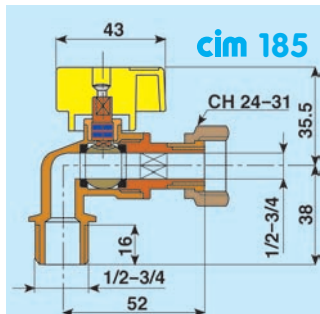

See technical sheet at page 184

DN1 x DN2	1/2x1/2	1/2x3/4	1/2x3/4	3/4x3/4
Ø mm.	9	9	15	15
Grms.	215	240	330	335
A	43	43	50	50
B1	39	39	52,5	52,5
B2	43	43	35	35
C	35	36	46	46
D1	17	17	15	13
D2	8	9	9	9
CH1	24	24	27	27
CH2	24	31	31	31



cim 150

RIGHT ANGLE BALL BIB COCK FOR GAS - UNI-CIG 7140



DN	1/2x8	1/2x10	1/2x13	1/2x15
Box	50	50	50	50
Cart.	100	100	100	100

cim 152



cim 151

RIGHT ANGLE BALL BIB COCK FOR GAS - UNI-CIG 9891



DN	3/8x1/2	1/2x1/2		
Box	50	50		
Cart.	100	100		

cim 153



cim 170

STRAIGHT BALL BIB COCK FOR GAS - UNI-CIG 7140



DN	1/2x8	1/2x10	1/2x13	1/2x15
Box	50	50	50	50
Cart.	150	150	150	150

cim 172

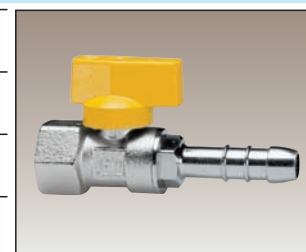

cim 171

STRAIGHT BALL BIB COCK FOR GAS - UNI-CIG 9891

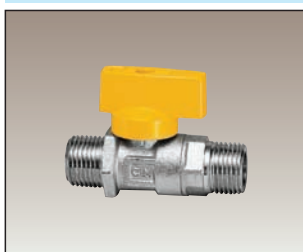

DN	3/8x1/2	1/2x1/2		
Box	50	50		
Cart.	100	100		

cim 173

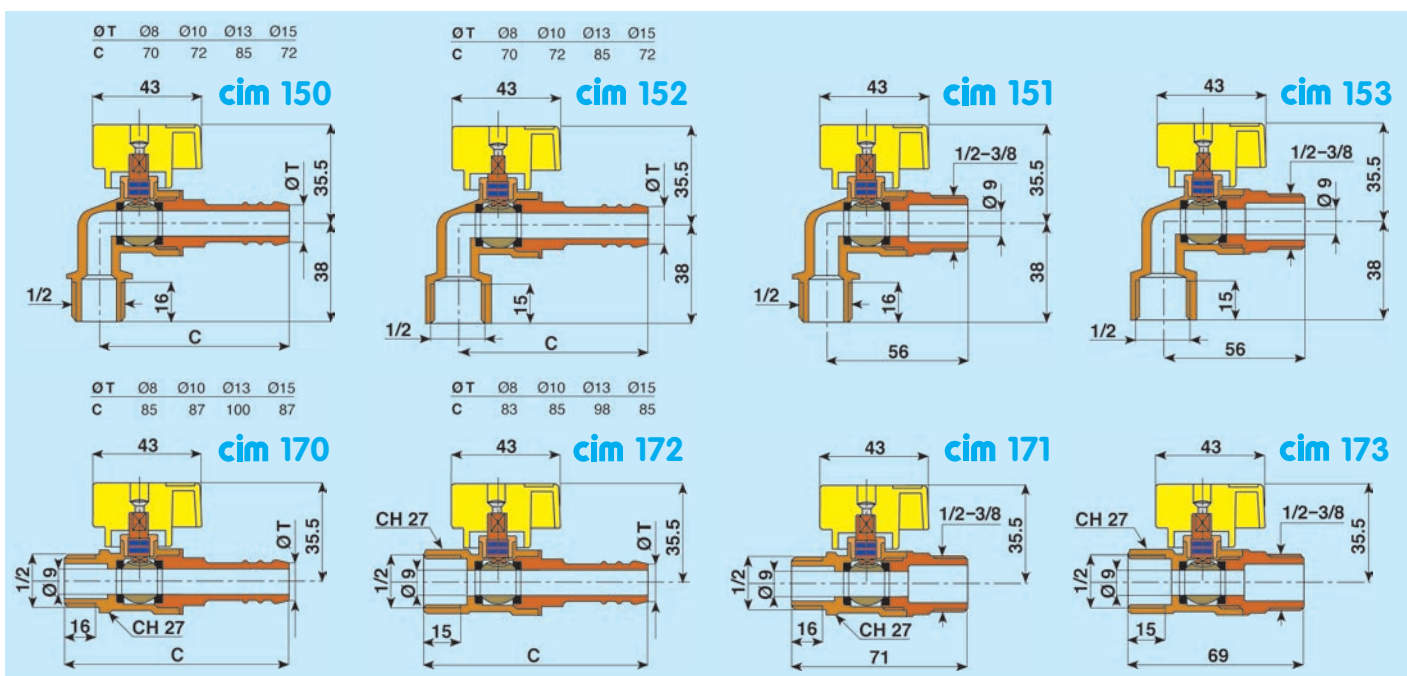

cim 150 PG

RIGHT ANGLE BALL BIB COCK FOR GAS
WITH "PRESS AND TURN" SAFETY HANDLE - UNI-CIG 7140

cim 152 PG



DN	1/2x8	1/2x10	1/2x13	1/2x15
Box	50	50	50	50
Cart.	100	100	100	100



cim 151 PG

RIGHT ANGLE BALL BIB COCK FOR GAS
WITH "PRESS AND TURN" SAFETY HANDLE - UNI-CIG 9891

cim 153 PG



DN	3/8x1/2	1/2x1/2
Box	50	50
Cart.	100	200



cim 170 PG

STRAIGHT BALL BIB COCK FOR GAS
WITH "PRESS AND TURN" SAFETY HANDLE - UNI-CIG 7140

cim 172 PG



DN	1/2x8	1/2x10	1/2x13	1/2x15
Box	50	50	50	50
Cart.	150	150	150	150

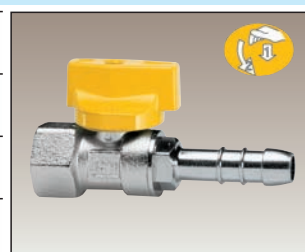

cim 171 PG

STRAIGHT BALL BIB COCK FOR GAS
WITH "PRESS AND TURN" SAFETY HANDLE - UNI-CIG 9891

cim 173 PG



DN	3/8x1/2	1/2x1/2
Box	50	50
Cart.	100	100



cim 185 PG

RIGHT ANGLE BALL BIB COCK FOR BOILERS
WITH "PRESS AND TURN" SAFETY HANDLE

cim 186 PG

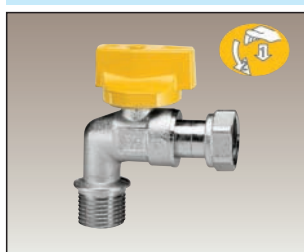

DN		1/2x1/2	1/2x3/4
Box		10	10
Cart.		100	100



cim 187 PG

STRAIGHT BALL BIB COCK FOR BOILERS
WITH "PRESS AND TURN" SAFETY HANDLE

cim 188 PG



DN		1/2x1/2	1/2x3/4
Box		50	50
Cart.		150	150



CIMFAST

Gas ball valve with integrated combined quick connector and automatic thermal disconnect

Approved CSA-UL – Patented

CIMFAST FEATURES

STREAMLINE DESIGN

Compact shape saves space

THERMAL SHUT-OFF

Shuts off low at internal temperatures up to 150°C

FLAT FACE QUICK DISCONNECT

Keeps dirt and grime from entering

EASY TURN HANDLE

Makes valve simple to operate

SAFETY SLEEVE

Can not disconnect gas connector until valve is shut-off
Can not open valve until gas connector is attached

CONNECTOR

AGA & CGA Certified. High quality, safest and longest lasting gas connectors for movable equipment.



The valve cannot be opened until the gas connector is properly attached.

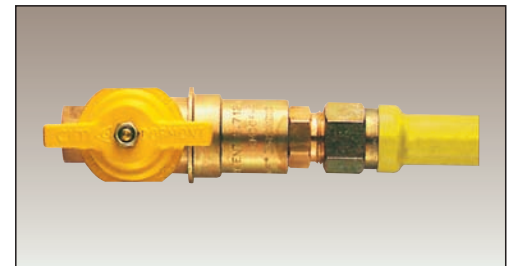

The gas connector cannot be disconnected until the gas valve is shut off.

COMPONENTS CIM 1001MA-FE - 1002 MA-FE

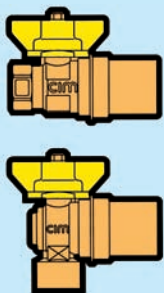

cim 1001 Fe

cim 1002 Fe

cim 1001 Ma

cim 1002 Ma

COMPONENTS CIM 1001MA-FE - 1002 MA-FE + 1003

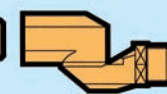
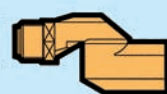
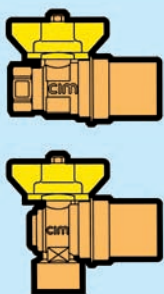

cim 1001 Fe

cim 1002 Fe

cim 1001 Ma

cim 1002 Ma

cim 1001

GAS BALL VALVE WITH COMBINED QUICK CONNECTOR AND AUTOMATIC THERMAL DISCONNECTOR DEVICE

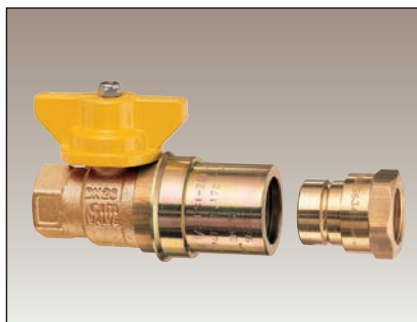

DN	1/2	3/4	1"

cim 1002



cim 1001 MA-FE

GAS BALL VALVE WITH COMBINED QUICK CONNECTOR AND AUTOMATIC THERMAL DISCONNECTOR DEVICE COMPLETE WITH STEEL FLEXIBLE

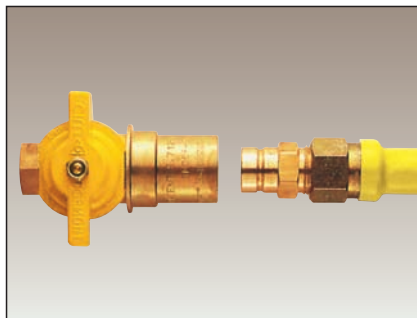

DN	1/2	3/4	1"

cim 1002 MA-FE



cim 1003

SUPR. SWIVEL - ARTICULATED FITTING

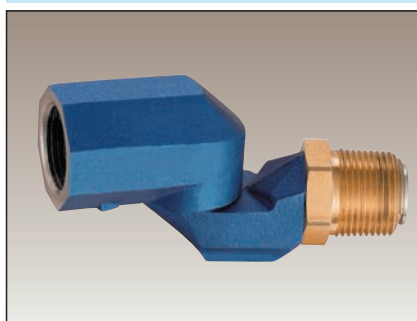

DN	1/2	3/4	1"

cim 1005

GAS BALL VALVE WITH COMBINED QUICK CONNECTOR AND AUTOMATIC THERMAL DISCONNECTOR DEVICE



DN	1/2x1/2	1/2x13 mm.

cim 1006



cim 1007

GAS BALL VALVE WITH COMBINED QUICK CONNECTOR AND AUTOMATIC THERMAL DISCONNECTOR DEVICE



DN	1/2x1/2	1/2x13 mm.

cim 1008





ASEISMATIC

SISMACim

Automatic safety shut-off valves for gas lines in the event of an earthquake

In an attempt to improve precautions against seismic risk, with regard to identification of areas of seismic activity and the technical standards for building in those areas, on **March 20th 2003 the Government passed a decree (No 3274) ordering that a number of guidelines**, documented in the decree and developed by experts in the field, should be adopted.

In addition to classifying areas of seismic activity, the document also lays down technical guidelines for the project - for the evaluation and seismic adaptation of building, bridges etc and the necessary reinforcement work.

Technical Document No 2 describes the calculation of stress and resistance tests for the structural elements of every type of building structure (reinforced concrete, steel, concrete...) Paragraph 4.10 (General Planning Criteria) focuses its attention on distribution systems with the following ruling for gas systems:

...“gas systems consuming more than 50m³/h should be provided with automatic safety shut-off valves for use in the event of an earthquake.”

It is a fact that damage caused by the seismic shock of an earthquake is almost always accompanied by fire and explosion, due to gas escaping from fractured pipelines.

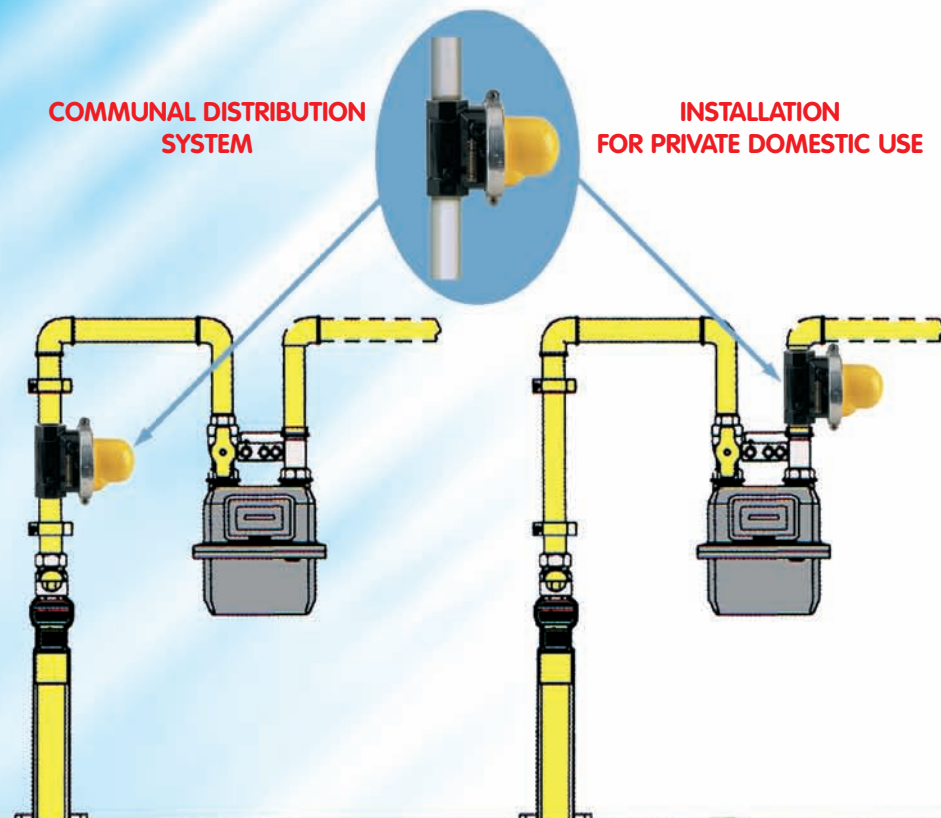

Technical features

SISMACIM California Series safety valves are designed and manufactured in accordance with the strict United States Aseismatic Standards ASCE 25-97 and totally meet the requirements of Italian law.

The **SISMACIM** safety valve comprises a shut-off valve with swing disc, which comes into action following vibrations caused by earthquake tremors (for interference level see diagram).

The level of interference at which the aseismatic device is triggered, is controlled by the following factors.

Requirements for activation

The device sensors should activate the stop mechanism within 5 seconds whenever they undergo horizontal sinusoidal oscillations with:

1. an acceleration peak of 0.70 g (6.87 m/s²) and a period of 0.13 seconds
2. an acceleration peak of 0.40 g (3.92 m/s²) and a period of 0.20 seconds
3. an acceleration peak of 0.30 g (2.94 m/s²) and a period of 0.40 seconds
4. an acceleration peak of 0.25 g (2.45 m/s²) and a period of 1 seconds

These conditions should be met for the horizontal axis of the sensors.

Requirements for non - activation

The device sensors should activate the stop mechanism within 5 seconds whenever they undergo sinusoidal oscillations with:

1. an acceleration peak of 0.40 g (3.92 m/s²) and a period of 0.10 seconds
2. an acceleration peak of 0.20 g (1.96 m/s²) and a period of 0.20 seconds
3. an acceleration peak of 0.15 g (1.47 m/s²) and a period of 0.40 seconds
4. an acceleration peak of 0.10 g (0.98 m/s²) and a period of 1 seconds

These conditions should be met for both the horizontal and vertical axis of the sensors.

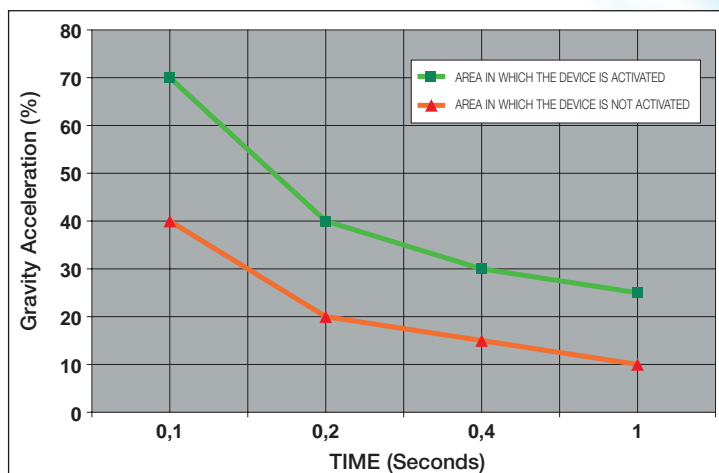

Function

The activation mechanism consists of a steel ball located in a conical cup support. The earthquake tremors dislodge the ball from the centre of the cup thus activating a shutter, which closes the valve.

The activation mechanism is set and sealed by the manufacturer.

All models are provided with an inspection window indicating the position of the shutter (GREEN Open/RED Closed) and the manual resetting device.

The valves do not require any form of electrical supply.

Important note

Once the automatic closing device has been set off by an earthquake tremor, **SISMACIM** Valves are designed to remain closed until they are manually reset.

The **SISMACIM** does not replace the main ball valve(s) for shutting off the gas supply upstream of the meter.



is designed for vertical installation with the gas flow inlet at the bottom. Three Models are available to match the working pressure of the system:

Cim 850: for **Domestic use**, maximum working pressure 0,035 bar in sizes DN 3/4 and DN 1".

Cim 851: for **Commercial use**, maximum working pressure 0,48 bar in sizes DN 1 and 1/4" and DN 1 and 1/2".

Cim 852: for **Commercial and Industrial use**, maximum working pressure 4,1 bar in sizes DN 3/4 and DN 4".

Cim 852F: for **Commercial and Industrial use**, maximum working pressure 4,1 bar in size DN 50 and DN 150.

cim 850-851-852

ASEISMATIC SAFETY VALVE CALIFORNIA SERIES VERTICAL INSTALLATION - BOTTOM INLET



Art.	Working pressure bar	3/4"	1"	1 1/4"	1 1/2"	2"	3"	4"
Cim 850	0,035							
Cim 851	0,48							
Cim 852	4,1							

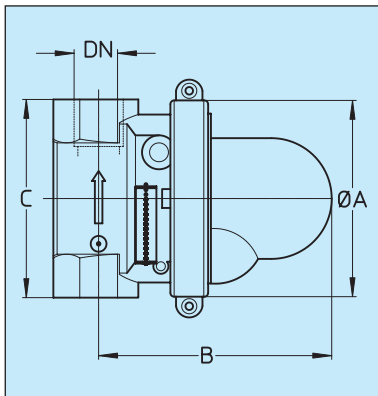

Cim 850	DN	3/4"	1"	1 1/4"	1 1/2"	2"	3"	4"
Cim 851								
Cim 852	Grms.	2300	2300	2800	2800	3300	3700	4600
	C	102	102	133	133	143	206	213
	B	121	121	127	127	133	143	159
	ØA	104	104	104	104	104	126	152

cim 852 F

ASEISMATIC FLANGED SAFETY VALVE - ANSI 150 VERTICAL INSTALLATION - BOTTOM INLET



Art.	Working pressure bar	2" x 50	3" x 80	4" x 100	6" x 150	8" x 200		
Cim 852 F	4,1							
Cim 852FH	4,1							

cim 852 FH ASEISMATIC FLANGED SAFETY VALVE - ANSI 150 HORIZONTAL INSTALLATION (ON REQUEST)

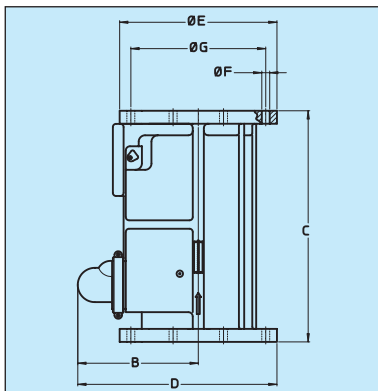

Cim 852 F	Ø mm.	2"	3"	4"	6"	8"	-	-
Cim 852 FH	Grms.	3700	5500	7300	13300	27900	-	-
	C	181	191	191	314	416	-	-
	B	137	137	162	191	244	-	-
	ØA	98	98	98	98	98	-	-
	D	213	232	276	330	410	-	-
	ØE	152	191	229	279	343	-	-
	ØF	19x4	19x4	19x8	19x8	22x8	-	-
	ØG	121	152	191	241	298	-	-

cim 855 Aseismatic circuit breaker

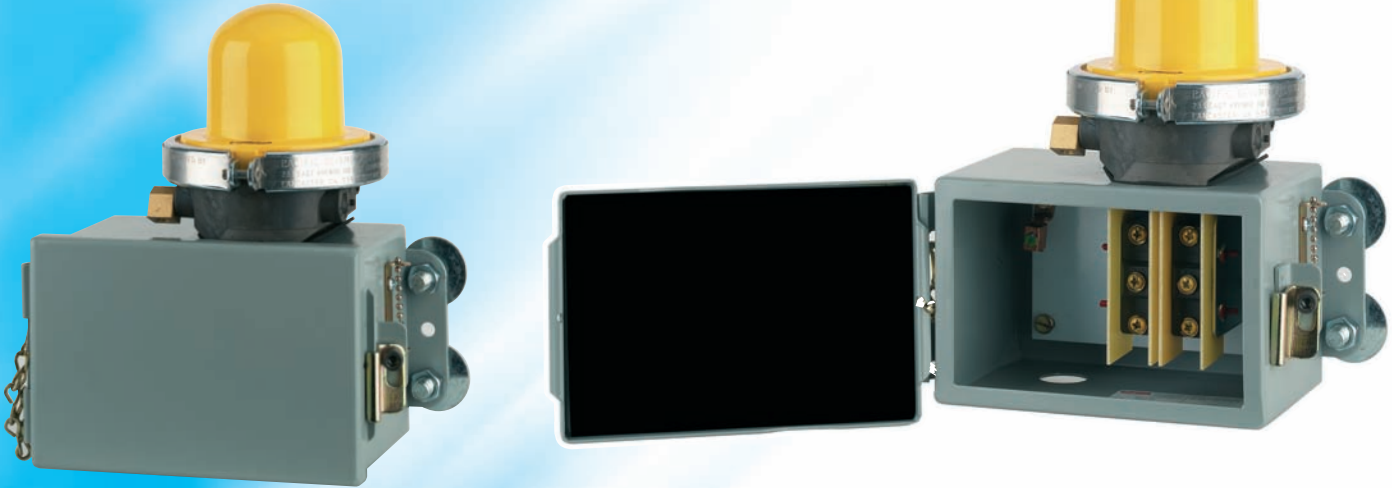

This aseismatic circuit breaker has been purpose-designed to immediately cut off the supply of electricity to any electrical device in the event of an earthquake. It is fixed firmly to the wall with brackets and leveled with the aid of small, regulating lugs. It is normally used in combination with specialist equipment to protect a number of designated electrical devices, or entire establishments. It is designed for connection to electrically or pneumatically operated valves and can seal off the flow of any type of fluid - thus avoiding the risk of leakage in the event of an earthquake.

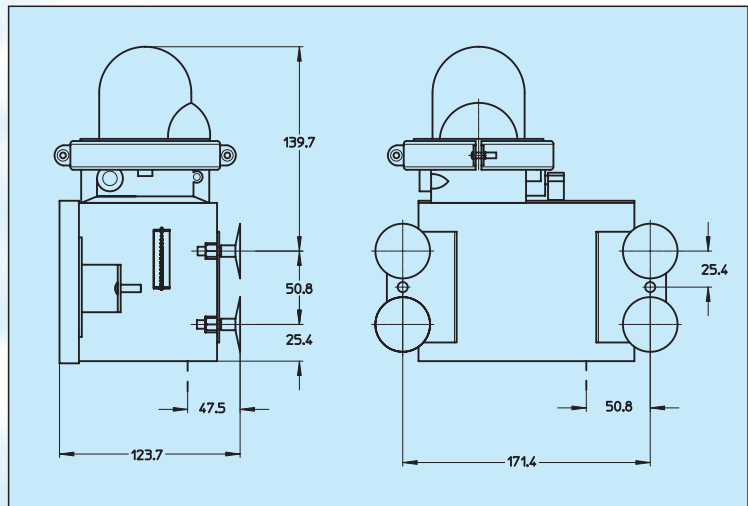

(*) Available as horizontal installation only.

cim 855K

SAFETY KIT SEISMICALLY TRIGGERED



DN	2 1/2"	3"	4"	5"	6"	8"
Ø mm.	65	80	100	125	150	200

THE KIT CIM 855K IS COMPOSED BY:
 No. 1 CIM 855 SEISMICALLY TRIGGERED CIRCUIT BREAKER
 No. 1 CIM 856 ELECTRO-VALVE MANUAL RE-SETTING NORMALLY CLOSED
 Maximum working pressure: 500 mbar

SEISMIC ZONE MAP - OPCM n° 3274 20/03/2003

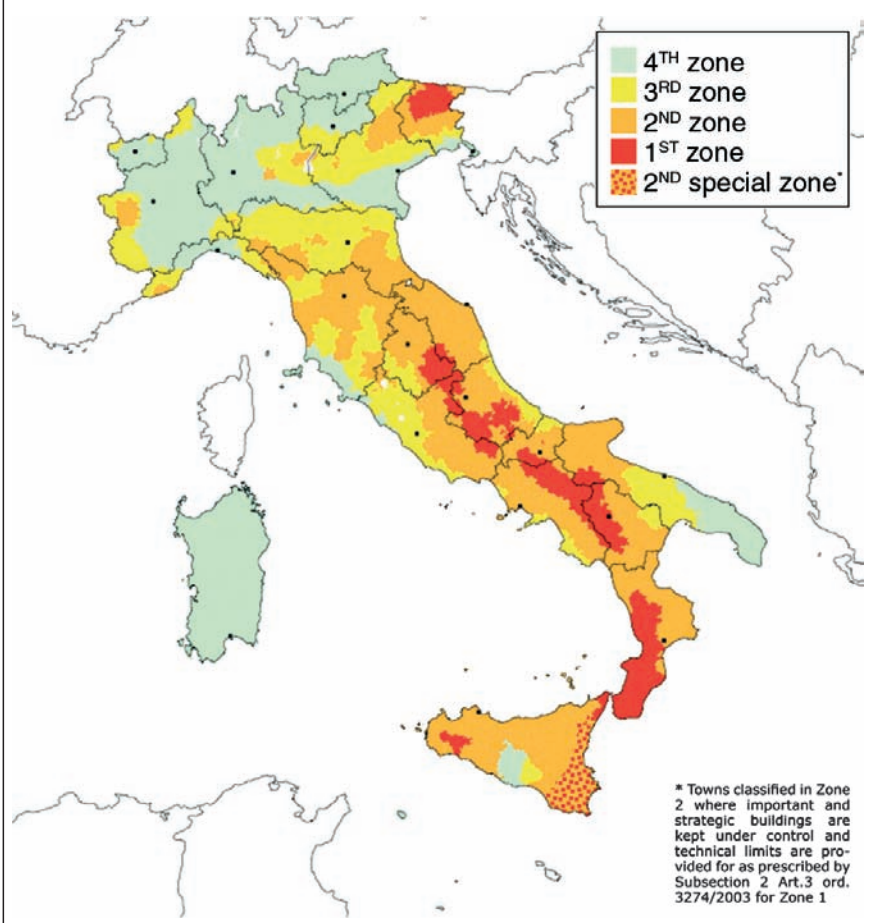

Installation

SISMACIM safety valves are available in thread sizes from 3/4" to 4" and are designed for vertical installation with the gas flow inlet at the bottom. Flow direction is indicated by the arrow forged on the valve body.

To ensure correct installation it is essential that the valve is:

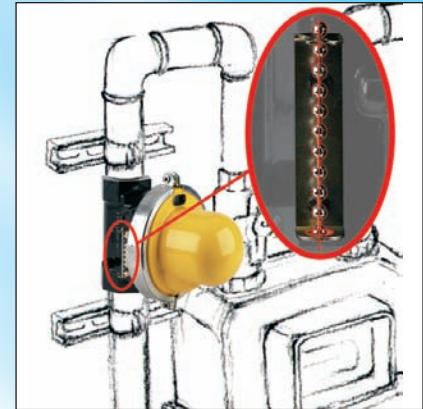

installed using the appropriate level control chain, which should be centred on the check ring when the valve is in the most favourable position;

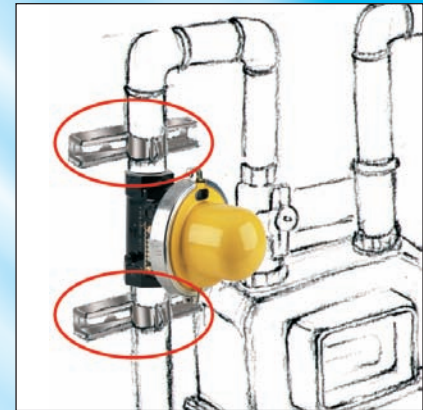

fixed firmly with a fixing bracket to keep the valve from triggering accidentally;

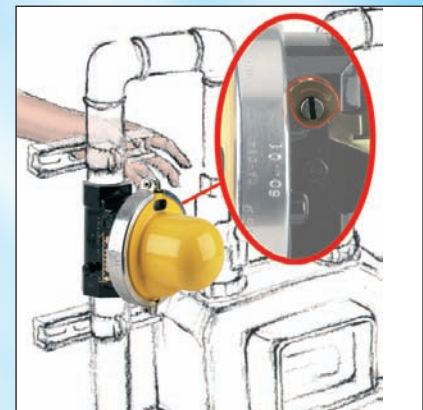

installed in such a way that the manual resetting mechanism is easily accessible.

LEVEL
CONTROL CHAIN

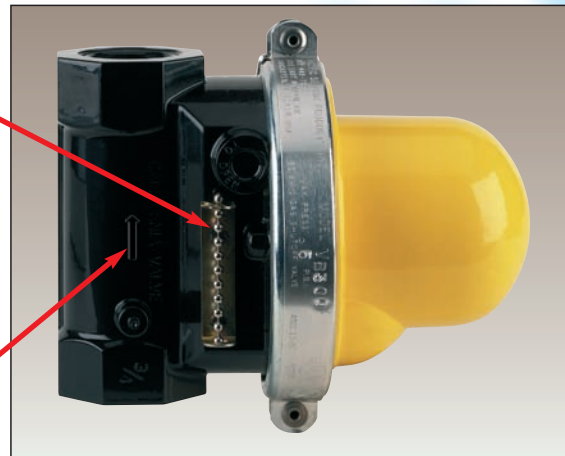

DIRECTIONAL
ARROW

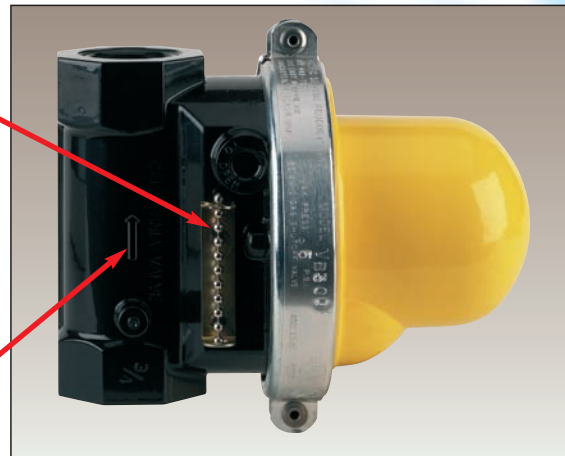

MANUAL RESETTING
LEVER

