

**Presentation :** The external probe regulates the temperature of the heating water according to the variation in outside temperature. The addition of a room thermostat ensures that the ambient temperature is maintained at a precise level.

**Application :** THEMATEK, THEMACLASSIC

**Kit contents :**

- 1 housing with sensor
- 2 screws and 2 wall plugs (supplied in the housing)
- 1 two-core cable 15 m long with 4-way screw connector
- 1 flat cable with connectors
- 1 probe card
- 1 probe card mounting screw

### Technical characteristics :

Overall dimensions of the probe housing (in mm) : Ø 70. Card power voltage (supplied by the boiler) : 24 V (DC).

Input / output connection : by screw connection to the probe printed circuit.

Operation adapted according to regional climatic conditions; 11 slopes are available by setting a **P1A** potentiometer on the probe printed circuit :

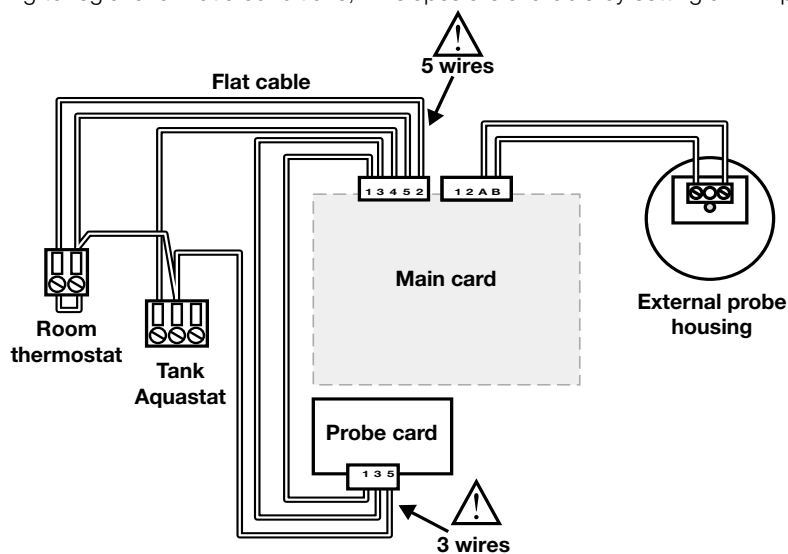

### Mounting instructions :

- Open the electrical box on the boiler.

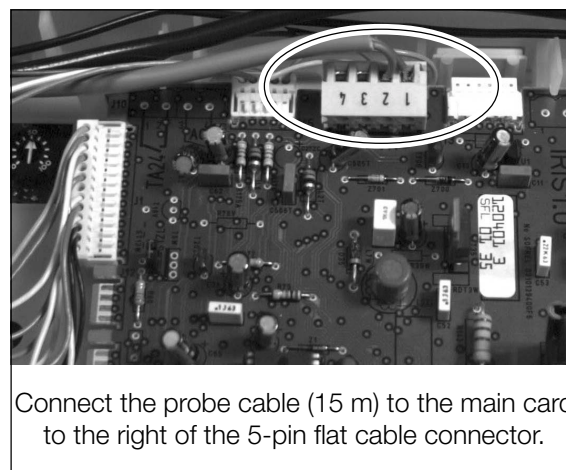
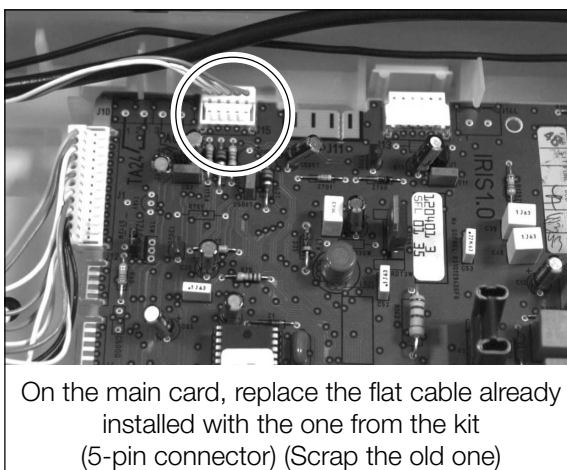
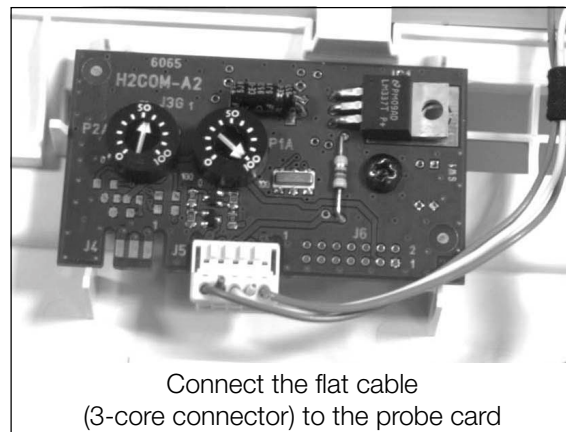
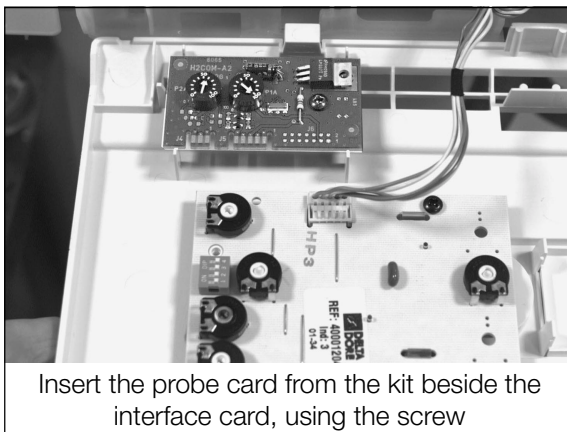

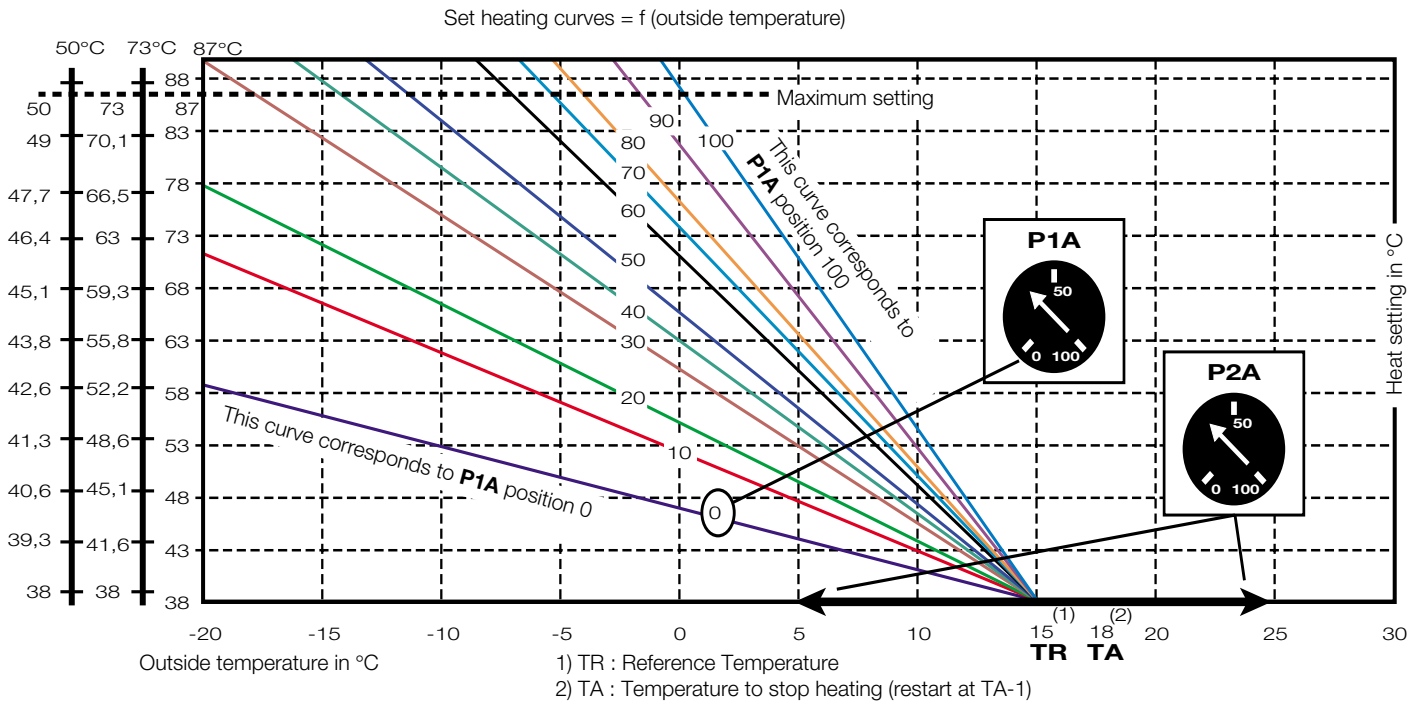
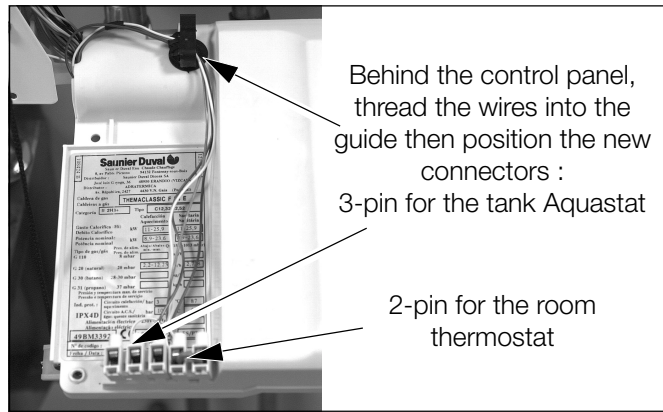

**Adjustment :**

- Set the **P1A** potentiometer to a choice of curves (0 to 100) according to your regional climatic conditions (**factory setting = 100**)
- **P2A** Potentiometer is used to offset the reference and stop temperatures at + or - a maximum of 10°C (**factory setting = 50**)

P2A	Reference temperature	Stop temperature
0	5°C	8°C
50	15°C	18°C
100	25°C	28°C

- Close the electrical box

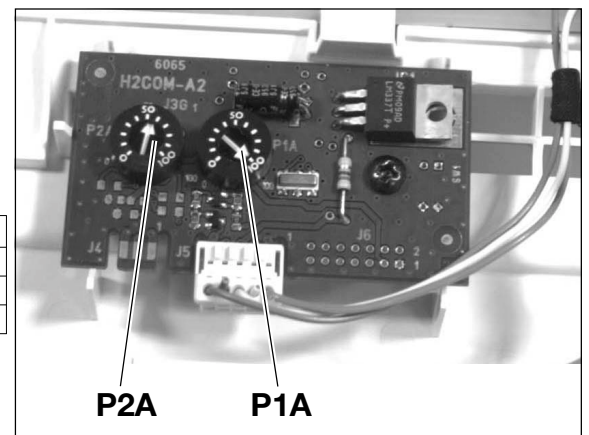

**IMPORTANT :**

When switching on, the boiler runs at maximum setting (50, 73 or 87°C) for one hour to heat the place more rapidly.