

CE PC M K ISO 9001 ISO 14001

Kiturami

Kiturami

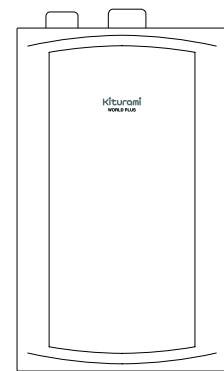

WORLDPLUS

• WORLDPLUS – 13 / 16 / 20 / 25 / 30

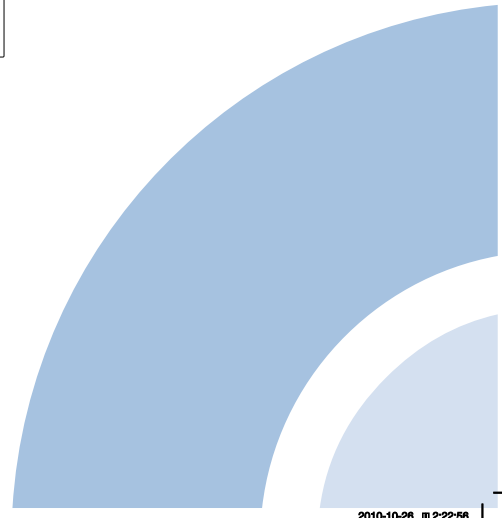
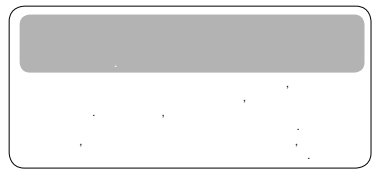



« »

1.		03
2.	« »	04
3.		05
4.		08
5.		11
6.		18
7.		22
8.		23
9.		24
10.		26
11.		27
12.		29
13.		41
14.		42
15.		43



?



« !», « », « !», :





« » « » « », « », » ,

. (. . . 10)

« » ,

. (. . . 11, 13, 17)

. 24 ~ 25) () . (

. (. . . 8, 11)

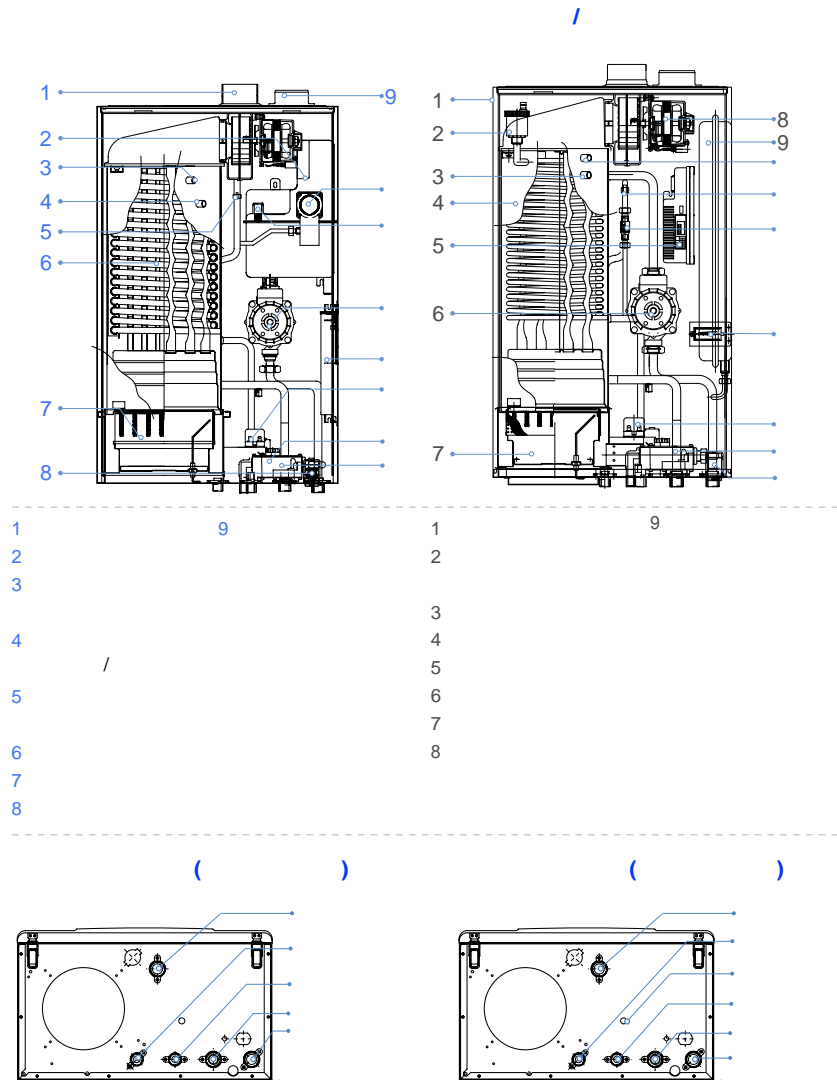



Kiturami

(GTX_5050N)

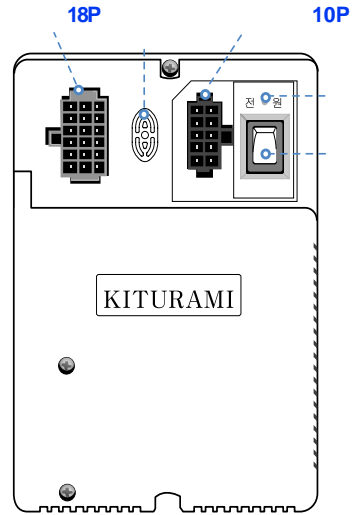
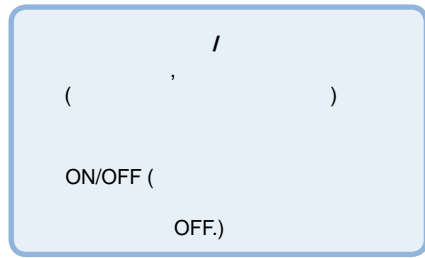

(GTX_6000)

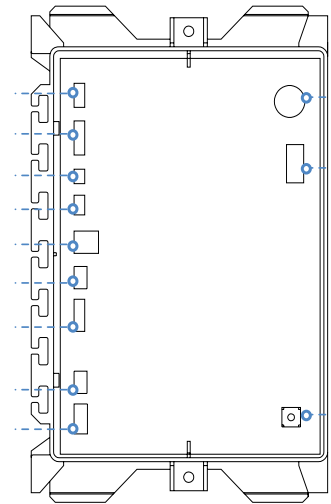
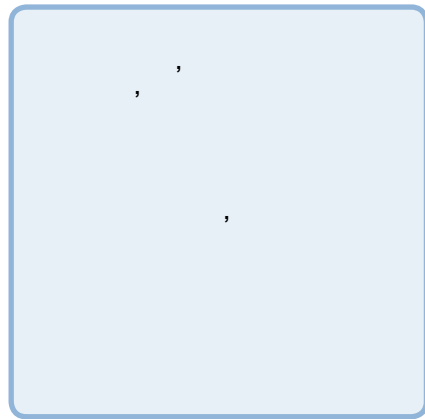

Kiturami

CTR-5700 PLUS

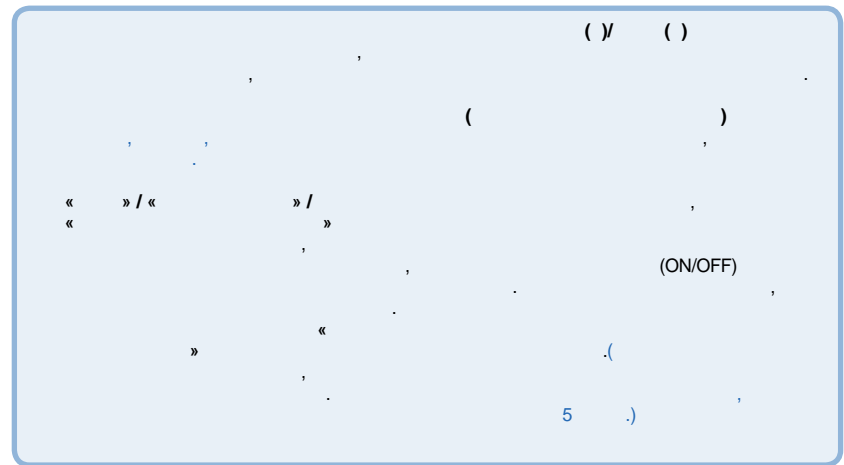
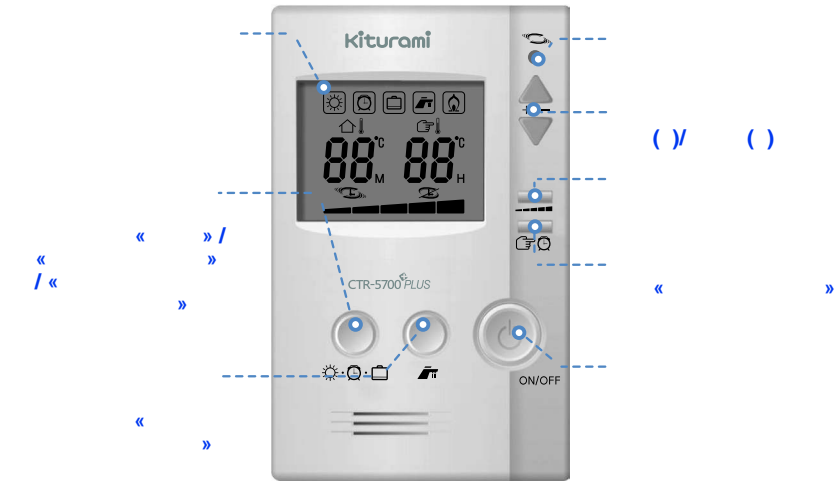



: :

(.)



: :

230 /50

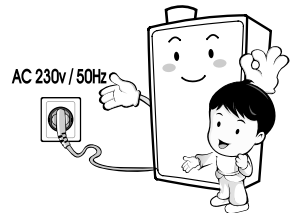

: :

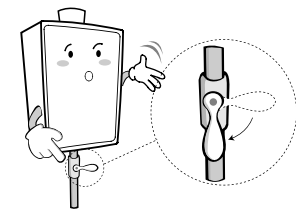

: :

No. 95

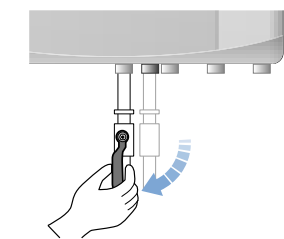

: :

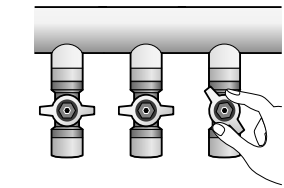

: :

(CO).

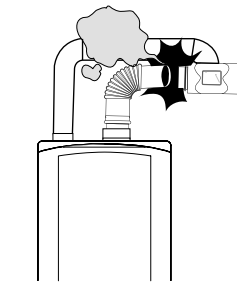



!



(30°C.)



!

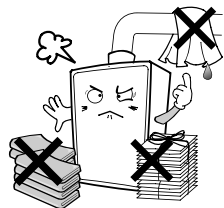

:

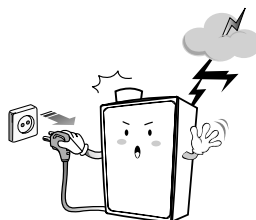

!



:



!



:

- 1.
- 2.
- 3.

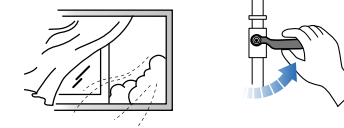

?



!



:



(

?

'97'



:

. (. . . 20)



:

“95”



:

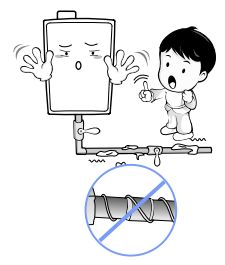

1.

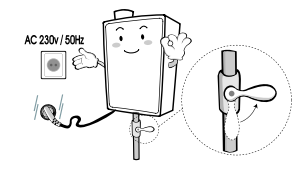

2.

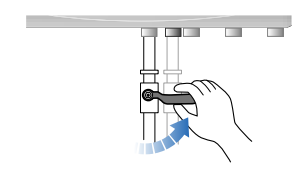

3.

4.

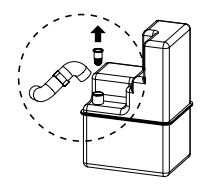

5.

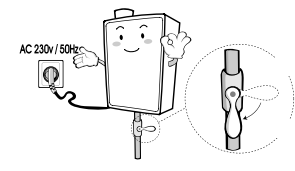



:

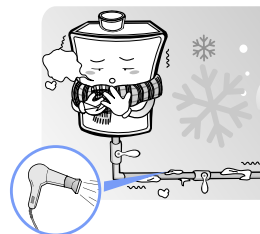

?



:

:

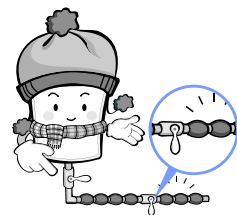

:



:

2-3

2-3

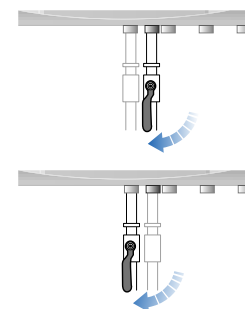

:

?

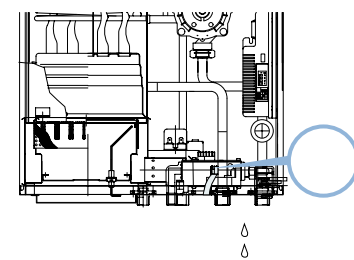

:

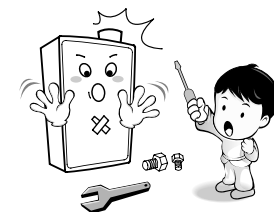



!

: 1



!

:

: 2

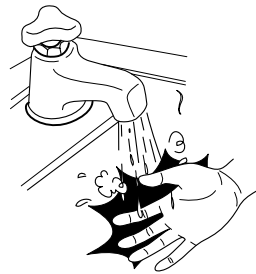

:

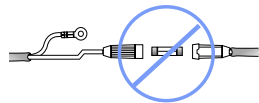

:

1-2

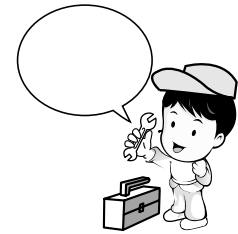

:

()

),

(

(2kgf/cm²)

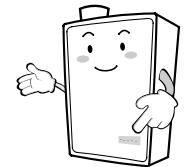

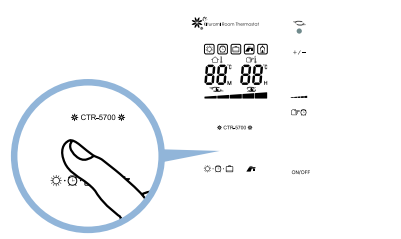
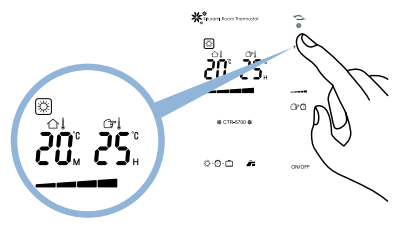
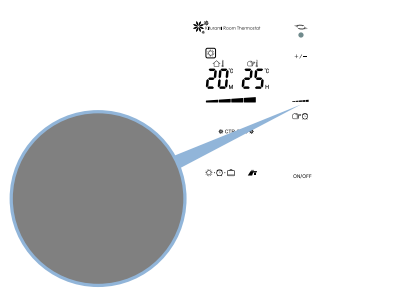

« » (CTR – 5700PLUS)

1. « », ()

2. () / ().

3. (< < < < < <)

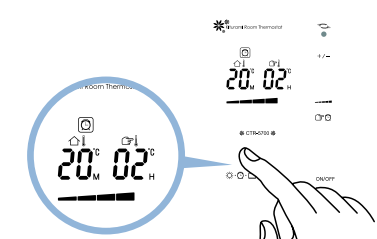
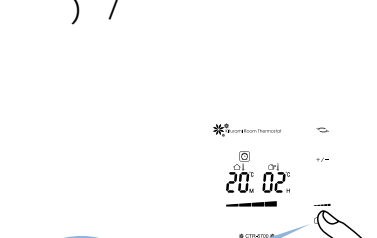
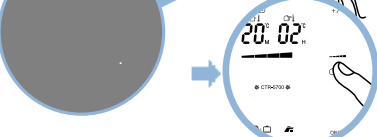
?

« » « ».

1. « », ()

2. ON

3. () / ()

- 4.

« »

()



1. ()

20.08

20.08

?

(ON)

10~15 C

?

-
-
-

(DHW).

1. DHW. (DHW)

2. DHW (2,5)

3. 147). 0,8 - 1,5 / 2 (78 -

20.38

20.38

1. 5

2. () ()

3. 1°C

85°C

20.38

20.38

5

38

-
-
-
-



01 / 02 / 03

Restart (Power/

04

05

06

07

08 (10), / 230

95/98 ((),)

96 (. . . 15-16.)

97 ? (97), ()



()

5 ()

«

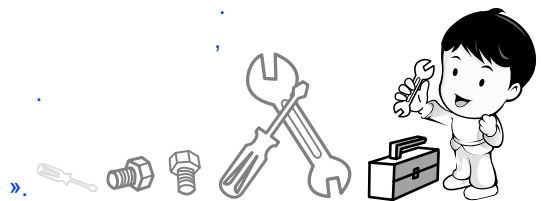

60 40

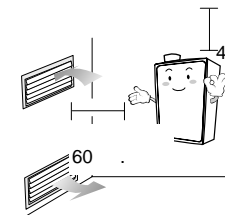

(CO).

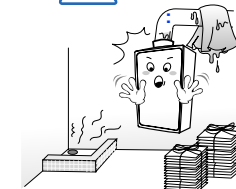

1

(CO)

30

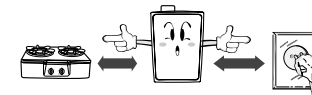

1

30

()



:

31æ1è°ü° Û
3.Ä°°÷¿i ¼³Äi ±ÝÁö



:

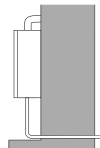

°Ö¿-¼° °®¿i ¼³Äi

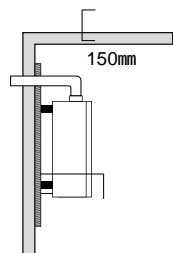

3



:

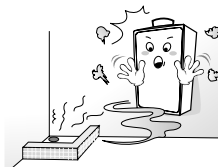

:

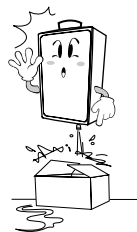

¿-¼°Ö±â±ÜÄ³¼³Äi±ÝÁö

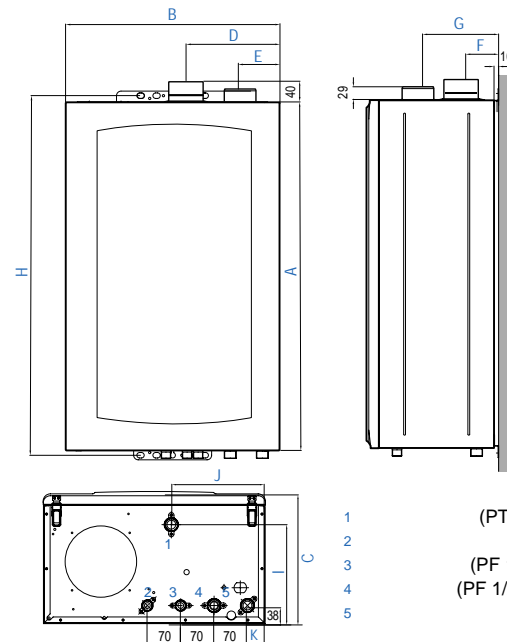

[10 ~ 30]

房種	A	B	C	D	E	F	G	H	I	J	K
10, 13	720	430	232	197.9	86.4	75.6	147.6	746	181.5	215	26
16, 20	761	465	278	203.5	101	81.8	175.8	786	202.9	222.8	37
25, 30	787	505	305	203.8	109.6	97.4	208.9	813	227.7	272.6	37

35 ~ 45



-(FF)

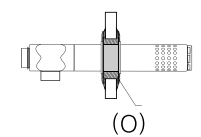
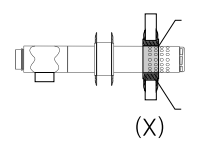
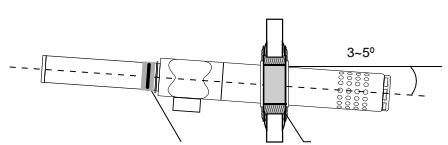
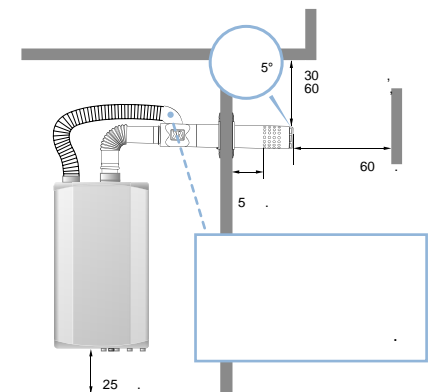
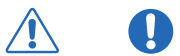

? (FE)

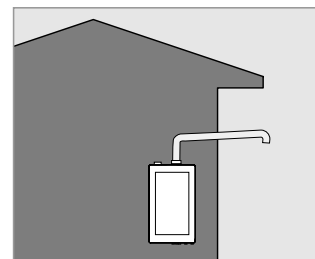

(X)

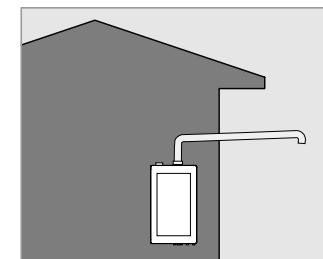

(O)

FE,





(FE)
FE (Forced Exhaust -)

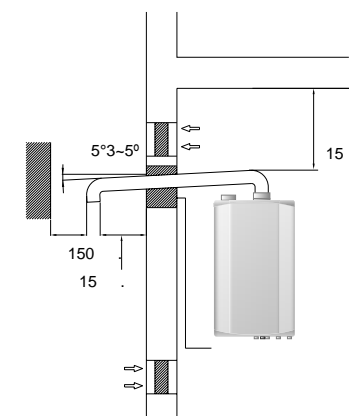

5°
1,6
60
2
FE
90°
(CO)
!

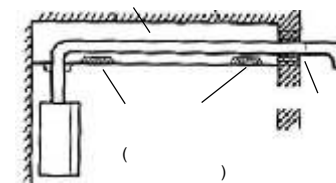
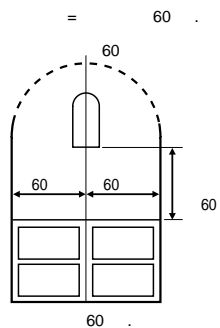

()
50
50
90
20

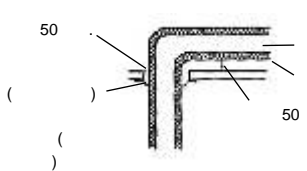



230 /50

230

230

230

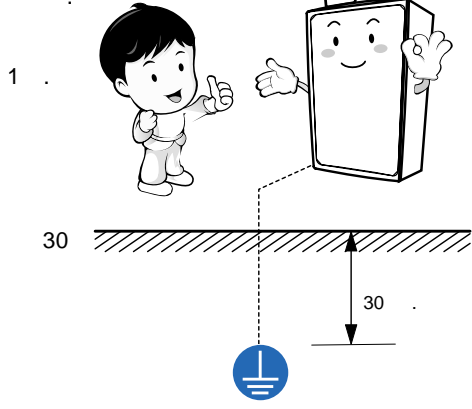

15A (PT 1/2).

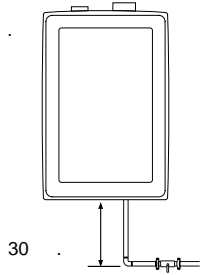

(15A)

30

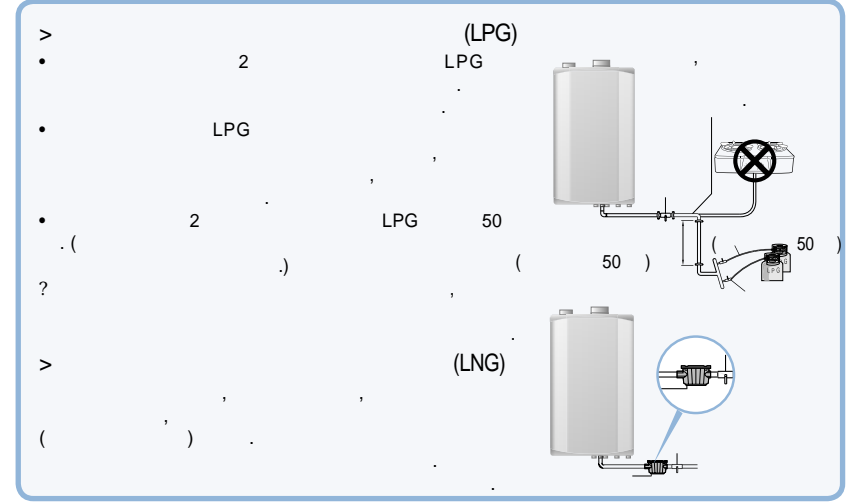

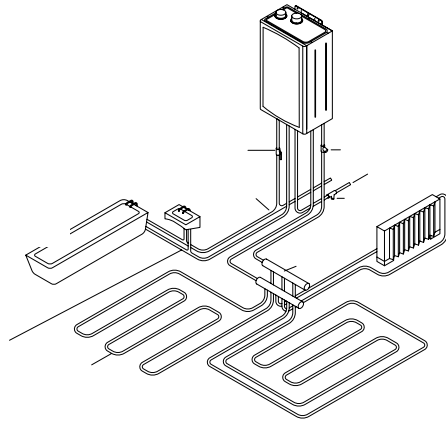

25K

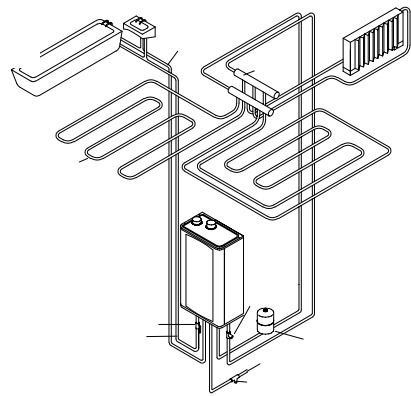

2.5 / 2.

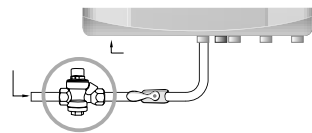

25

15A (PT 1/2)

1/100 ~ 1/200



15A (PT 1/2)



20A (PF 3/4).

36

44



$$A = Q \times 0.6 \times K \times P$$

A: (mm²)
 Q: (/)
 K: [1]
 F: [2]
 P: (mm²)

1.0	1.3	1.4
-----	-----	-----

[2]

	1	2	3	4	5	6	7	8	9	10	11	12	13	14	15	16	17	18	19	20	21
(F)	1.00	1.00	1.00	0.95	0.92	0.89	0.86	0.84	0.82	0.81	0.80	0.80	0.80	0.79	0.79	0.78	0.78	0.77	0.76	0.76	0.75

1:1.4

W:D

2

MOCIE, 08. 1998.



1

1.2 ~ 1.5

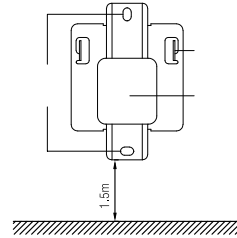

2

(CTR-5700PLUS).

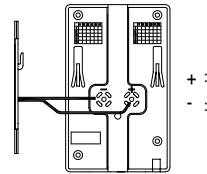

3

(CTR-5700PLUS)

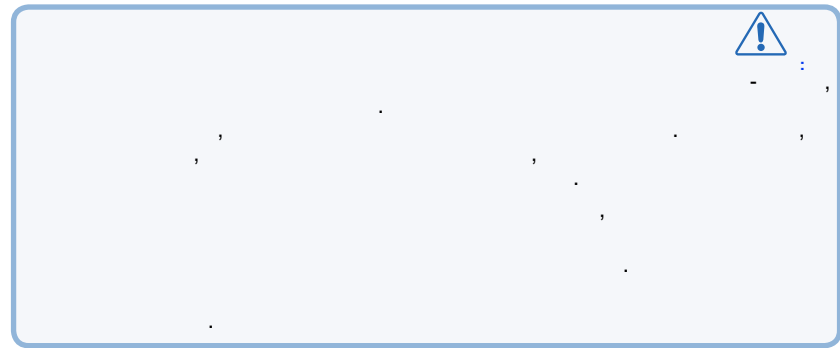
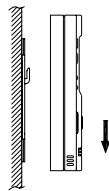

?





Kiturami

Kiturami



Kiturami

Kiturami