

GRUNDFOS INSTRUCTIONS



# MAGNA3

Further product documentation



[net.grundfos.com/qr/i/98091805](http://net.grundfos.com/qr/i/98091805)

be  
think  
innovate

**GRUNDFOS** 



MAGNA3



MAGNA3 D

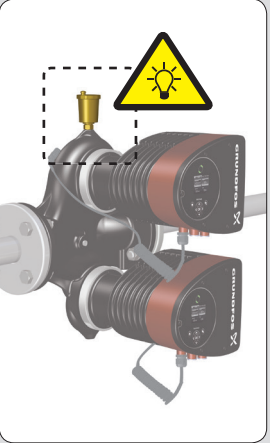



Max. 95 % RH  
IPX4D



Min./Max.  
-10 °C – +110 °C



PN 6:6 bar / 0.6 MPa  
PN 10:10 bar / 1.0 MPa  
PN 16:16 bar / 1.6 MPa



Min./Max.  
0 °C – +40 °C



< 55 dB(A)



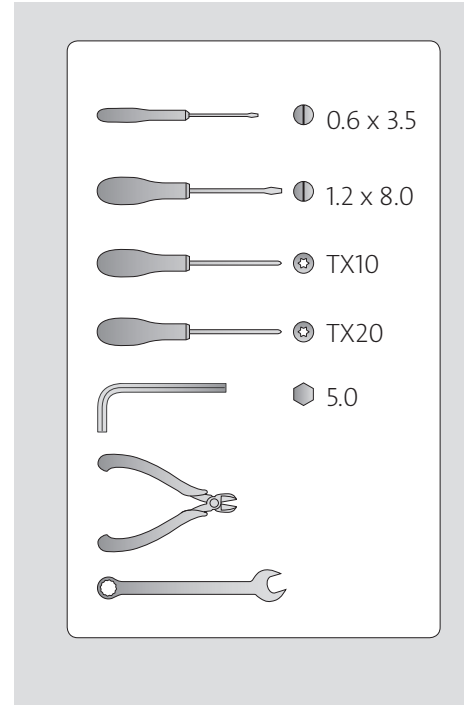
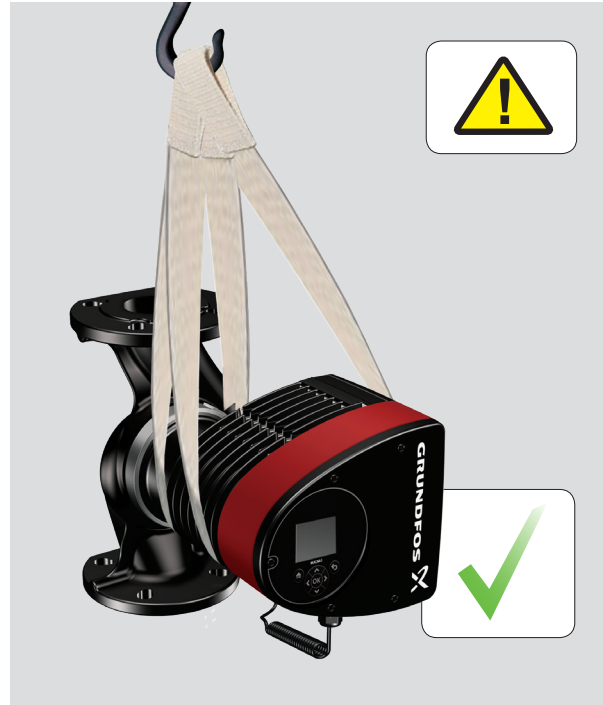



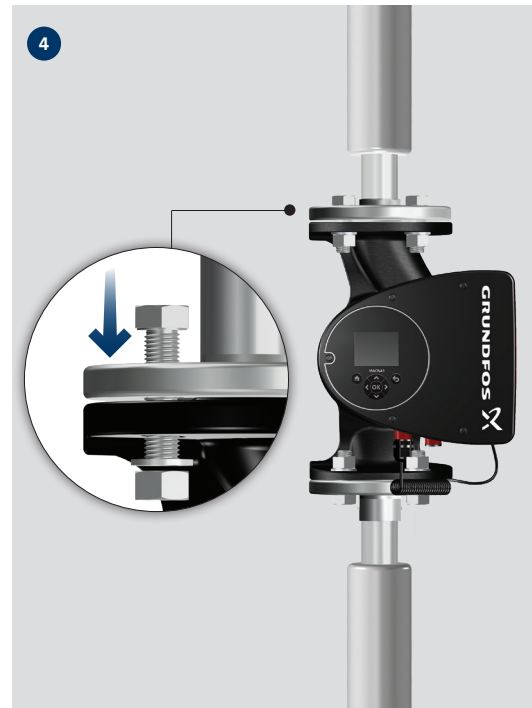
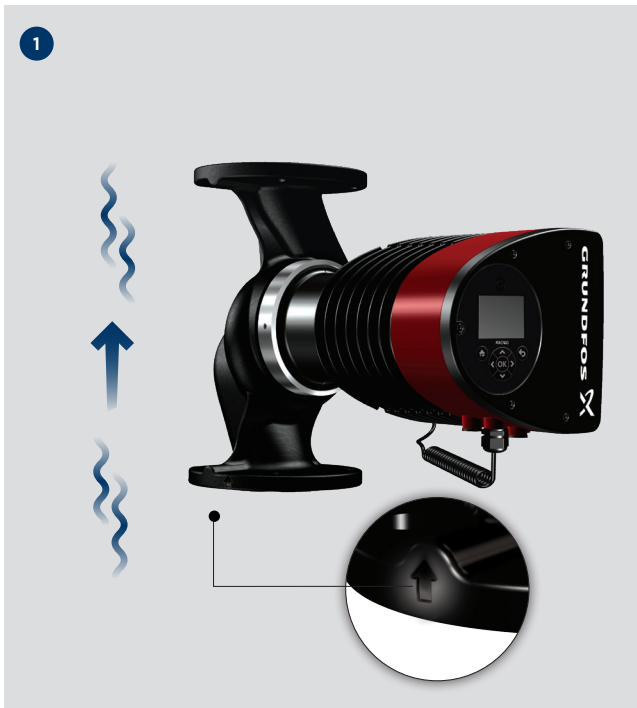

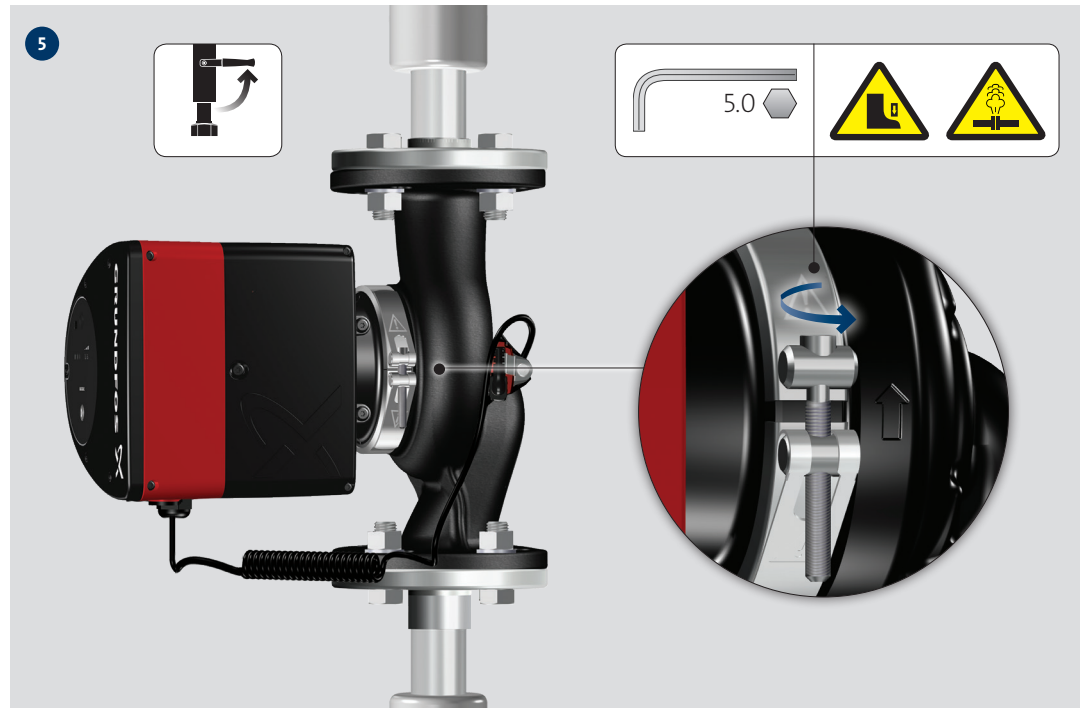
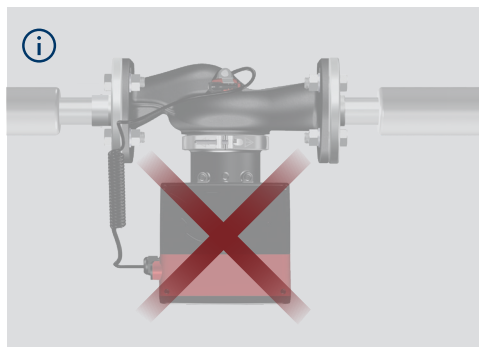
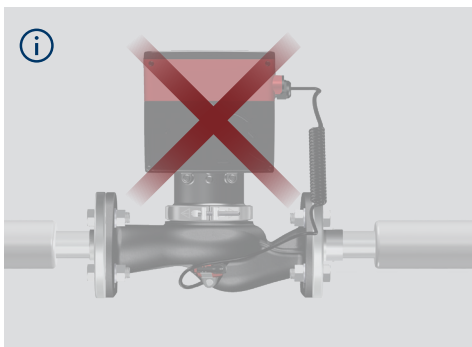
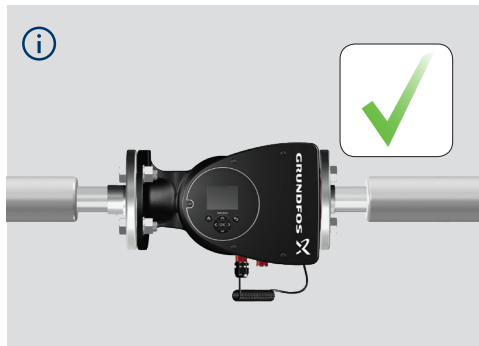
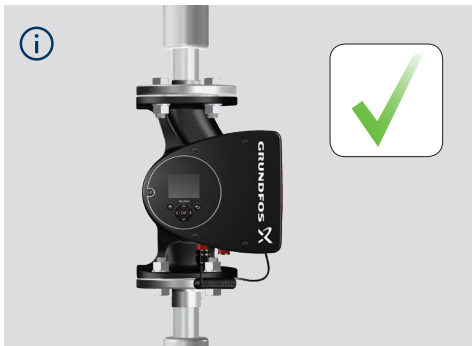

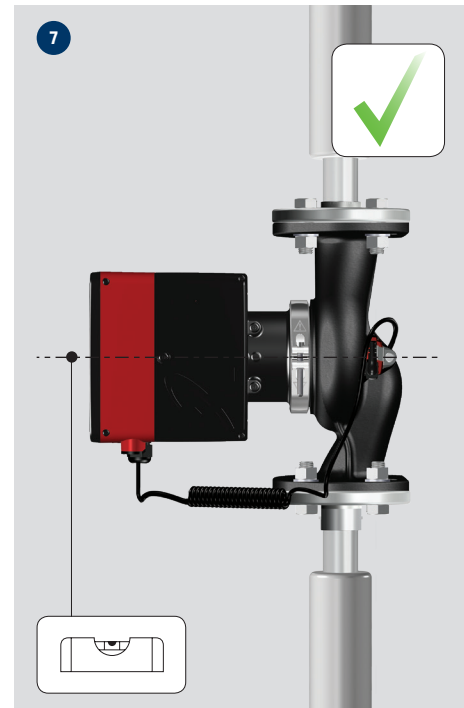
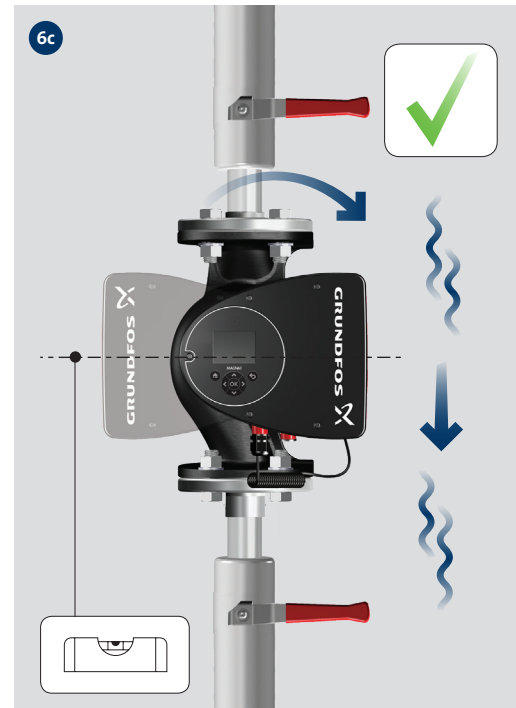
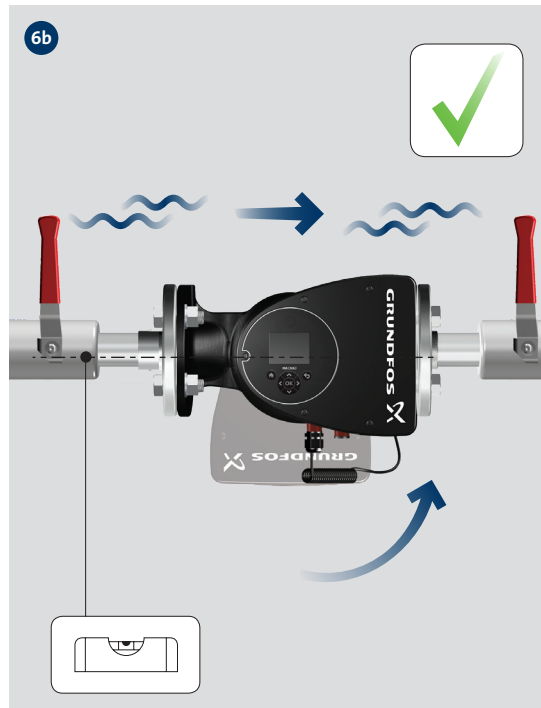
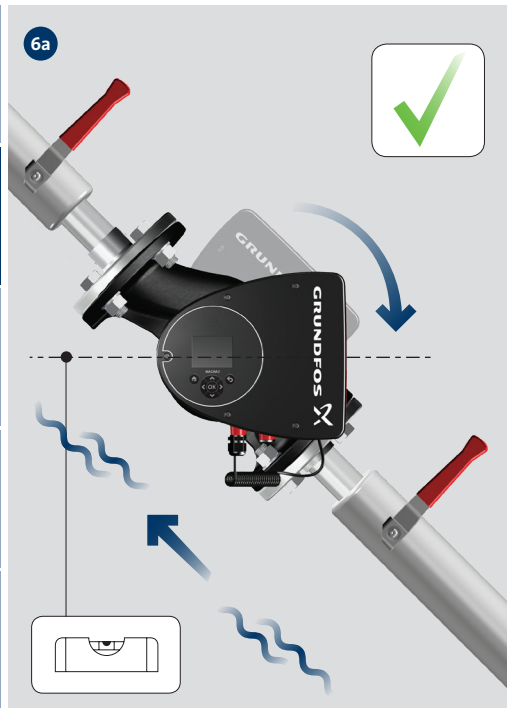



8

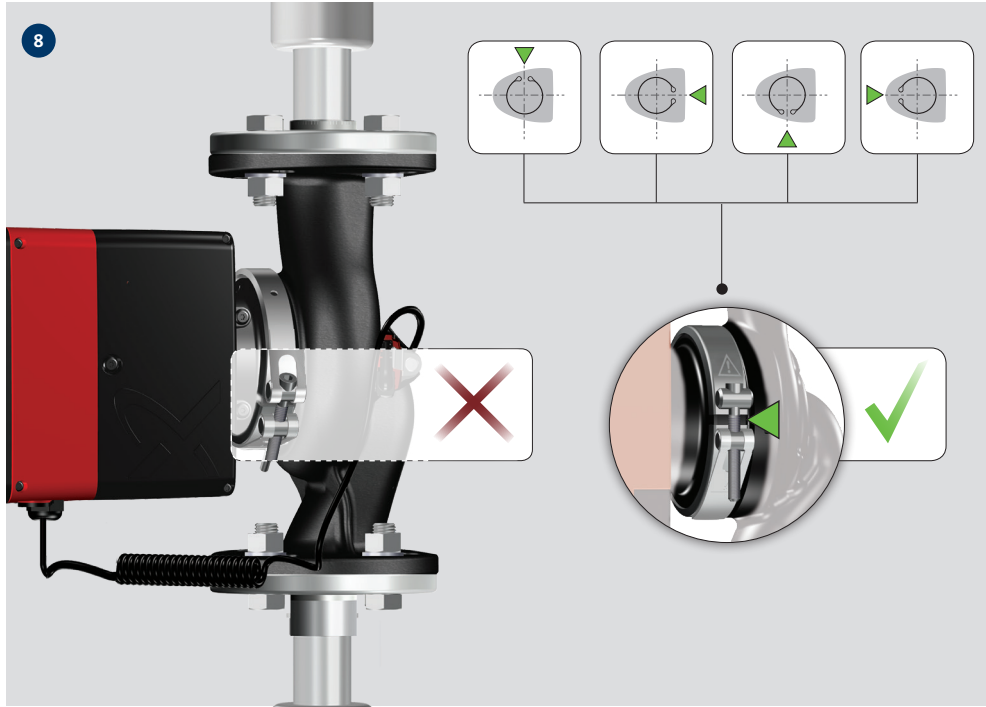

9

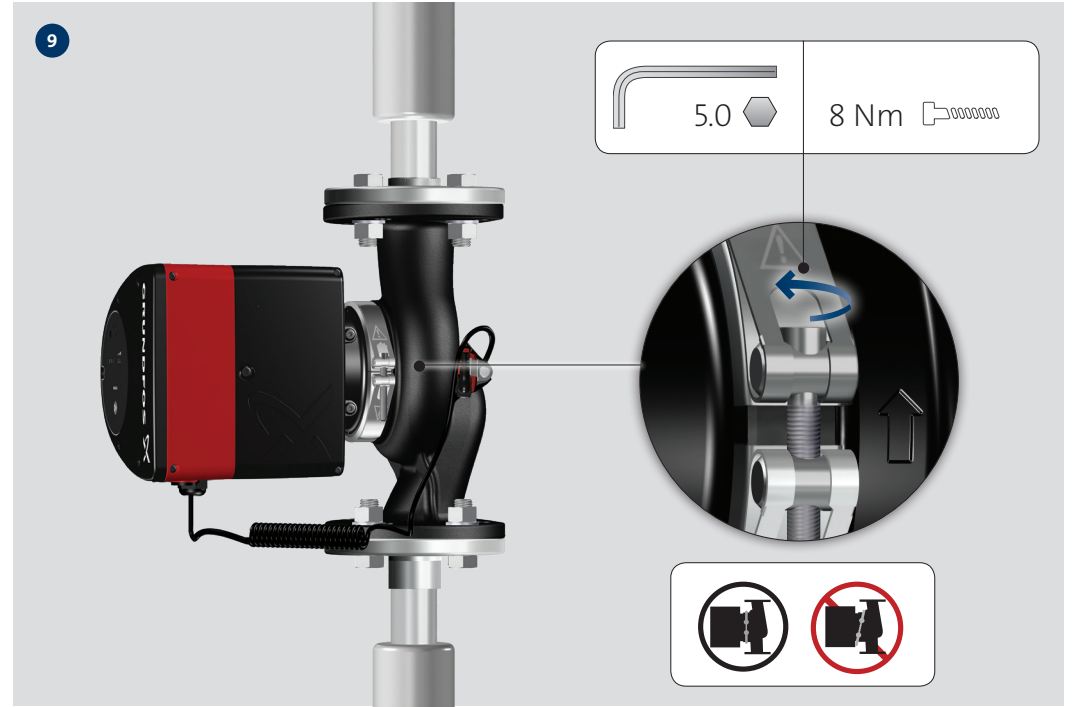



10



11





12

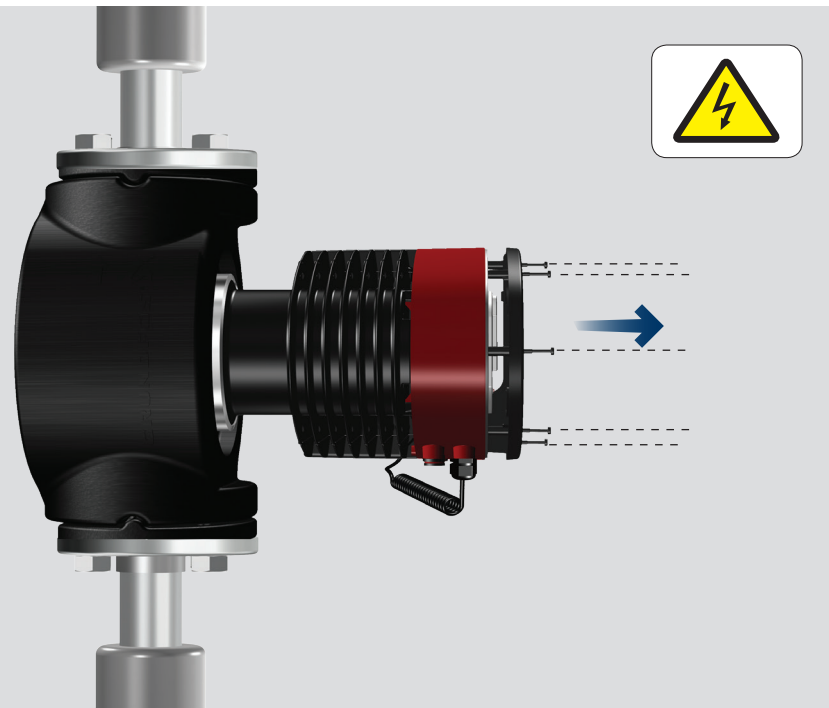

13

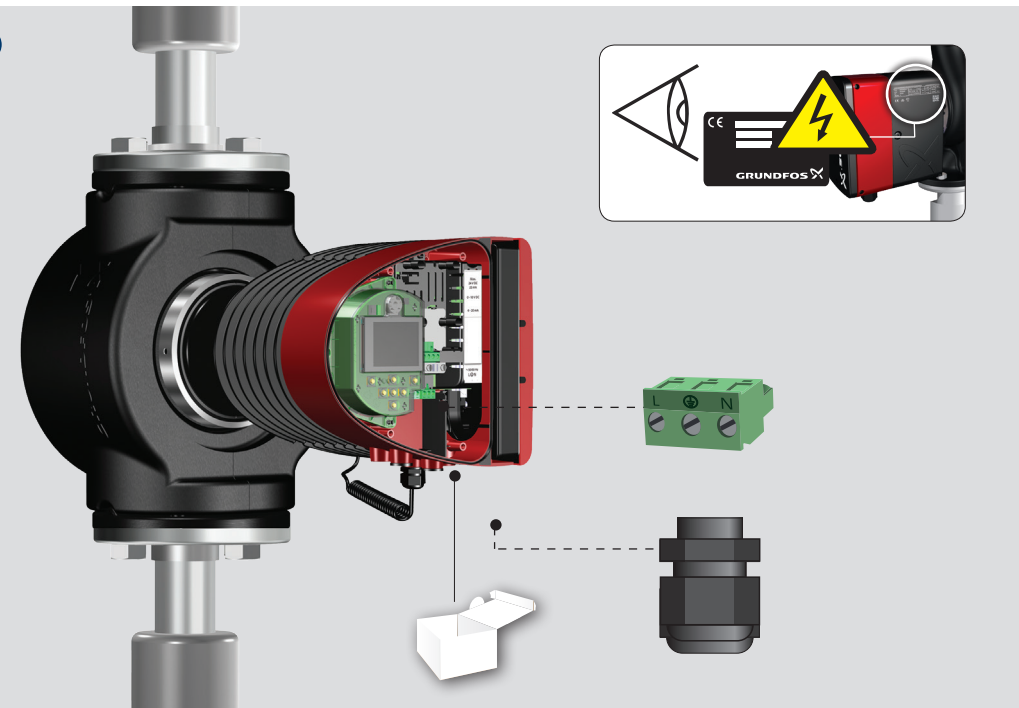

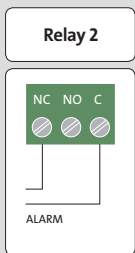
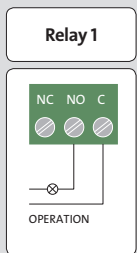
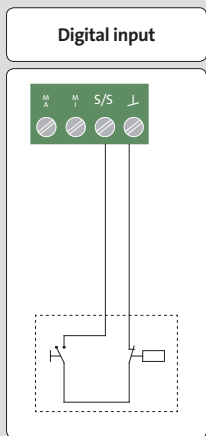
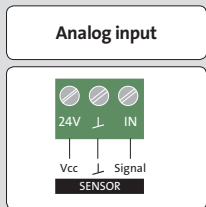

Use C and NC for fault signals as this enables serial connections of more relays and detection of signal cable defects.

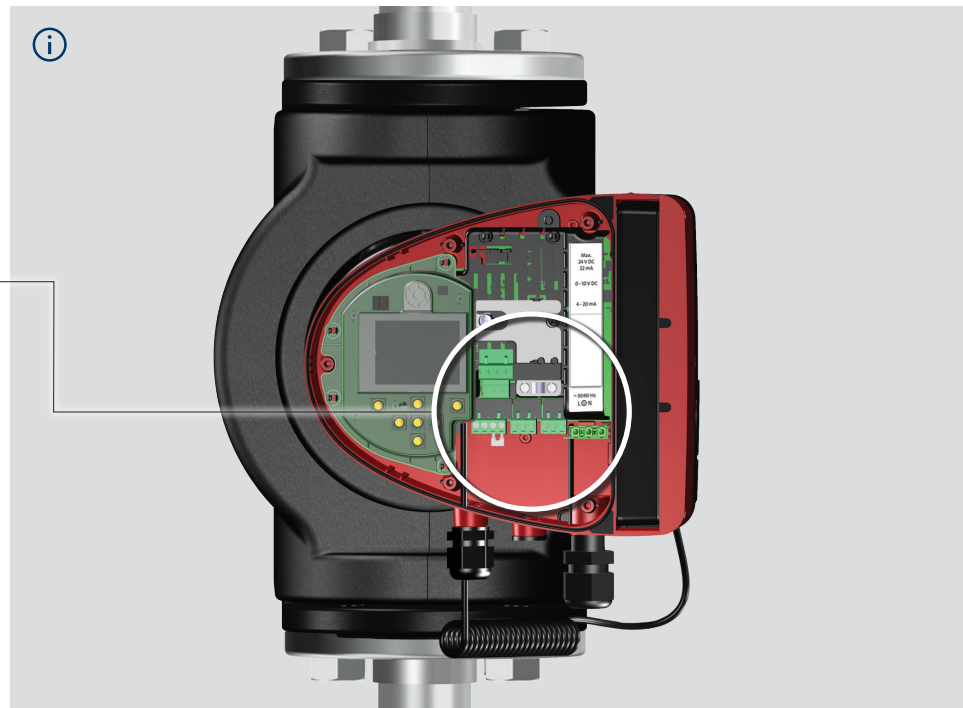
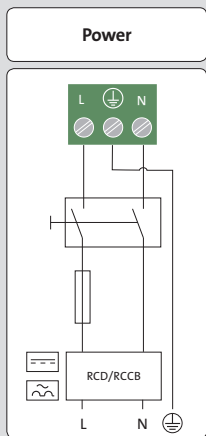

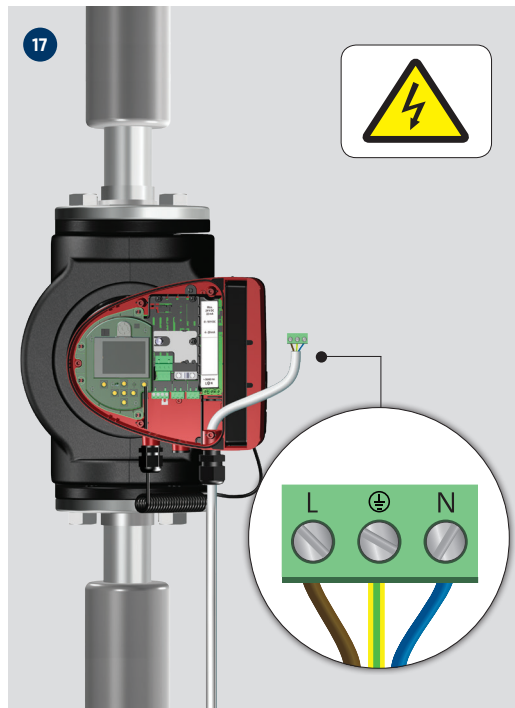
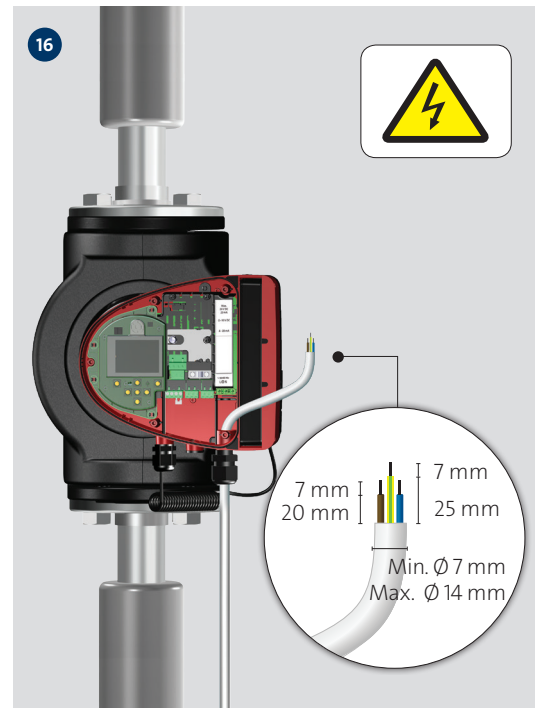
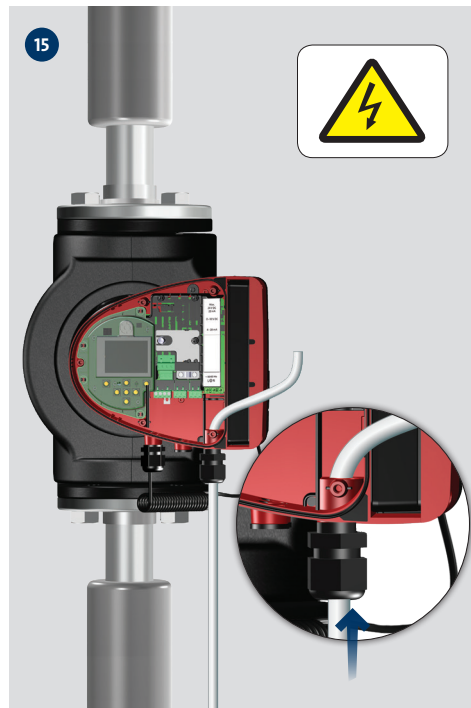
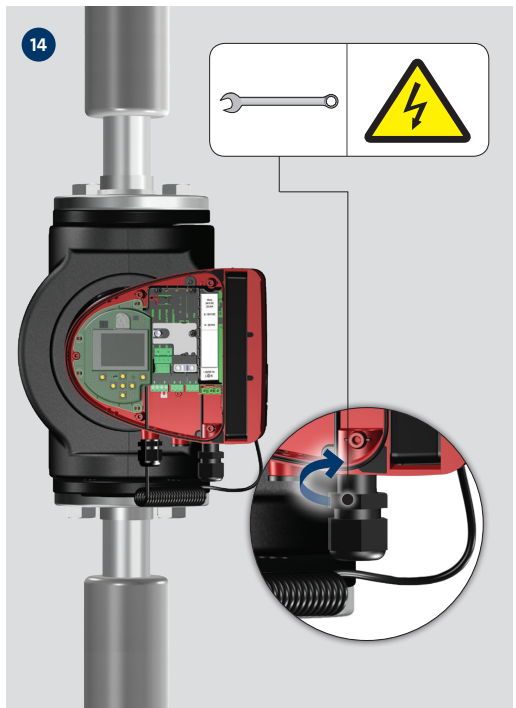





18

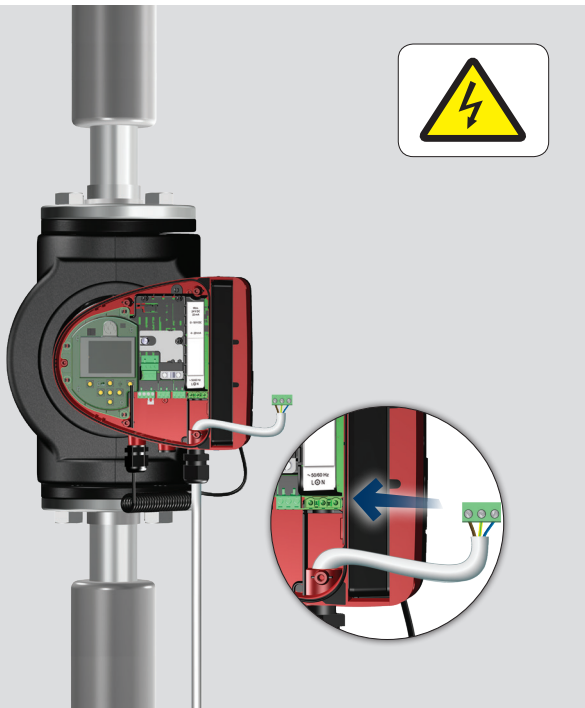

19

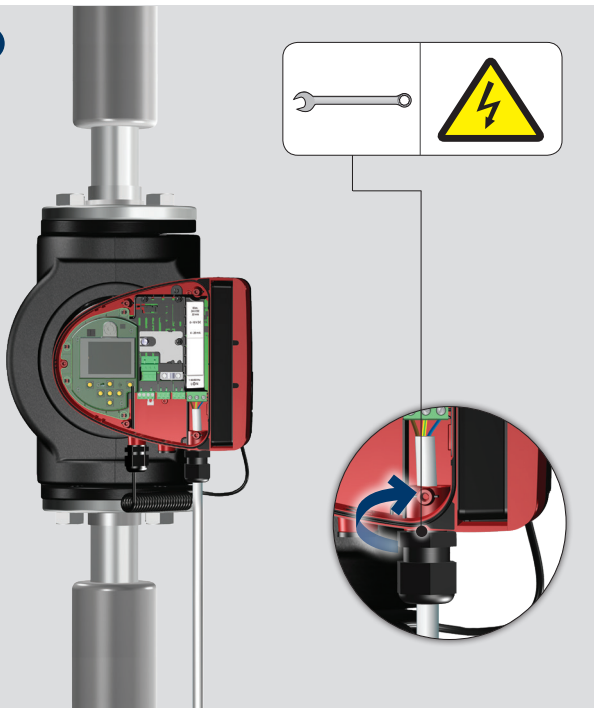

20

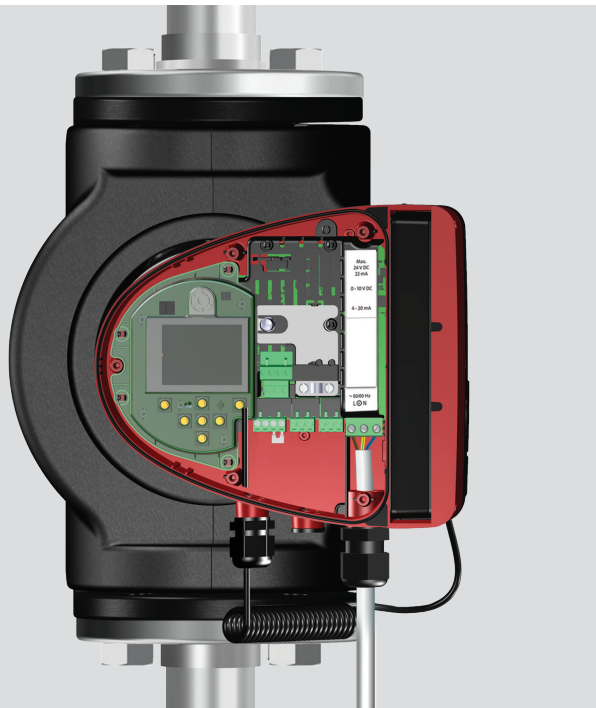



21

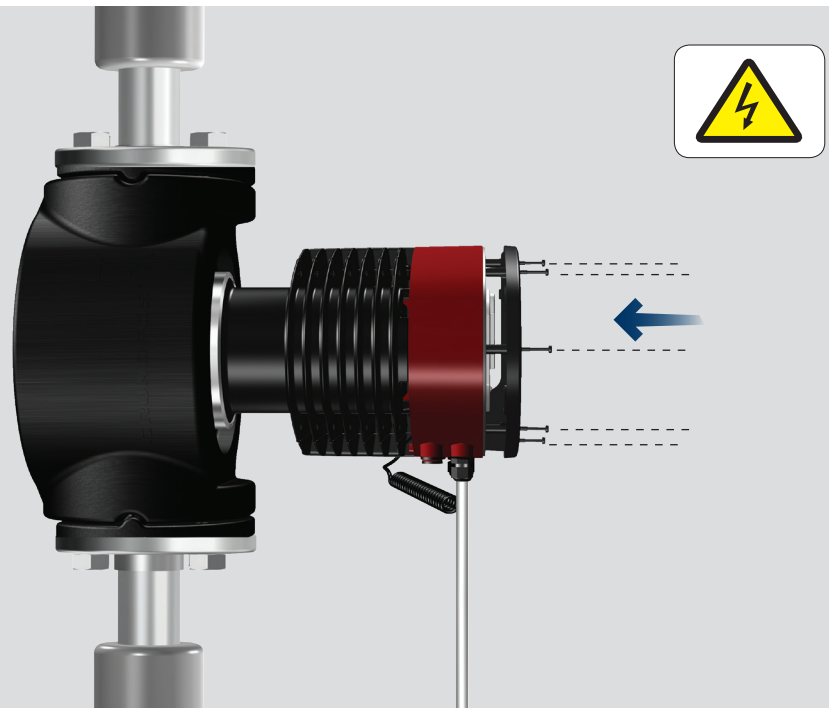

22





23



**Power cycle**  
Max. 4 starts  
per 60 minutes



24



Further product documentation

[net.grundfos.com/qr/i/98091805](https://net.grundfos.com/qr/i/98091805)





---

---

---

---

---

---

---

---

---

---

---

---

---

---

---

---

---

---

---

---

Installation date: \_\_\_\_\_

Installer:

\_\_\_\_\_  
\_\_\_\_\_  
\_\_\_\_\_  
\_\_\_\_\_

98091803 0219

ECM: 1253737

**GRUNDFOS Holding A/S**  
Poul Due Jensens Vej 7  
DK-8850 Bjerringbro  
Tel: +45 87 50 14 00  
[www.grundfos.com](http://www.grundfos.com)

**GRUNDFOS** 